

B-52G U.S.A.F

Stratofortress strategic Bomber



搜模閣

UA72202
1:72
SCALE

modelcollect 

B-52G U.S.A.F STRATOFORTRESS STRATEGIC BOMBER



"B-52" and "BUFF" redirect here. For other uses, see B-52 (disambiguation) and BUFF (disambiguation). The Boeing B-52 Stratofortress is an American long-range, subsonic, jet-powered strategic bomber. The B-52 was designed and built by Boeing, which has continued to provide support and upgrades. It has been operated by the United States Air Force (USAF) since the 1950s. The bomber is capable of carrying up to 70,000 pounds (32,000 kg) of weapons, and has a typical combat range of more than 8,800 miles (14,080 km) without aerial refueling.

Beginning with the successful contract bid in June 1946, the B-52 design evolved from a straight wing aircraft powered by six turboprop engines to the final prototype YB-52 with eight turbojet engines and swept wings. The B-52 took its maiden flight in April 1952. Built to carry nuclear weapons for Cold War-era deterrence missions, the B-52 Stratofortress replaced the Convair B-36. A veteran of several wars, the B-52 has dropped only conventional munitions in combat. The B-52's official name Stratofortress is rarely used; informally, the aircraft has become commonly referred to as the BUFF (Big Ugly Fat Fucker).

The B-52 has been in active service with the USAF since 1955. As of December 2015, 58 were in active service with 10 in reserve. The bombers flew under the Strategic Air Command (SAC) until it was disestablished in 1992 and its aircraft absorbed into the Air Combat Command (ACC); in 2010 all B-52 Stratofortresses were transferred from the ACC to the newly created Air Force Global Strike Command (AFGSC). Superior performance at high subsonic speeds and relatively low operating costs have kept the B-52 in service despite the advent of later, more advanced aircraft, including the canceled Mach 3 B-70 Valkyrie, the variable-geometry B-1 Lancer, and the stealth B-2 Spirit. The B-52 completed sixty years of continuous service with its original operator in 2015. After being upgraded between 2013 and 2015, it is expected to serve into the 2050s.

General characteristics

Crew: 5 (pilot, copilot, weapon systems officer, navigator, electronic warfare officer, and tail gunner until the removal of the tail gun in 1991)

Length: 159 ft 4 in (48.5 m)

Wingspan: 185 ft 0 in (56.4 m)

Height: 40 ft 8 in (12.4 m)

Wing area: 4,000 sq ft (370 m²)

Airfoil: NACA 63A219.3 mod root, NACA 65A209.5 tip

Empty weight: 185,000 lb (83,250 kg)

Loaded weight: 265,000 lb (120,000 kg)

Max. takeoff weight: 488,000 lb (220,000 kg)

Fuel capacity: 47,975 U.S. gal (39,948 imp gal; 181,610 L)

Zero-lift drag coefficient: 0.01119 (estimated)

Drag area: 47.60 sq ft (4.42 m²)

Aspect ratio: 8.56

Powerplant: 8 × Pratt & Whitney TF33-P-3/103 turbofans, 17,000 lbf (76 kN) each

Performance

Maximum speed: 560 kn (650 mph, 1,047 km/h)

Cruise speed: 442 kn (525 mph, 844 km/h)

Combat radius: 4,480 mi (3,890 nmi, 7,210 km)

Ferry range: 10,145 mi (8,764 nmi, 16,232 km)

Service ceiling: 50,000 ft (15,000 m)

Rate of climb: 6,270 ft/min (31.85 m/s)

Wing loading: 120 lb/ft² (586 kg/m²)

Thrust/weight: 0.31

Lift-to-drag ratio: 21.5 (estimated)

Armament

Guns: 1 × 20 mm (0.787 in) M61 Vulcan cannon originally mounted in a remote controlled tail turret on the H-model, removed from all current operational aircraft in 1991
Bombs: Approximately 70,000 lb (31,500 kg) mixed ordnance; bombs, mines, missiles, in various configurations.

Avionics

Electro-optical viewing system that uses platinum silicide forward looking infrared and high resolution low-light-level television sensors

ADR-8 chaff rocket (1965–1970)

LITENING Advanced Targeting System

Sniper Advanced Targeting Pod

IBM AP-101 computer

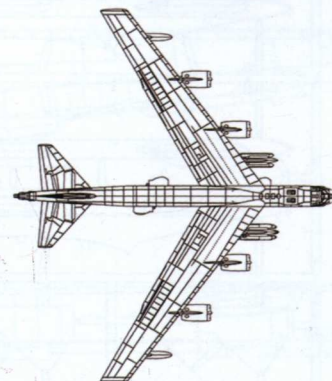

●READ BEFORE ASSEMBLY

1. When you use glue or paint, do not near flame, and use in a well-ventilated room.
2. Take extra care in handling photo etch parts in order to avoid injury
3. When you take parts off the runner frame, use modeling scissors and trim excess plastic with a cutter or a file.
4. Glue and paint are not included.
5. This product is only suitable for experienced more than 14 years old.

●装配之前仔细阅读:

1. 勿于近火处使用胶水或油漆, 并打开窗户保持空气流通。
2. 取蚀刻片时应特别注意安全, 防止利边划伤手指。
3. 从胶架上取出部件时, 应用模型专用剪, 并用界刀或小锉除去多余的胶料。
4. 请使用塑料胶水和油漆, 模型内不含。
5. 本产品不适合14岁以下没有经验的模型爱好者。

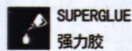

SUPERGLUE
强力胶

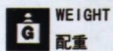

WEIGHT
配重

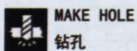

MAKE HOLE
钻孔

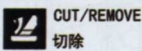

CUT/REMOVE
切除



BEND
弯曲



FILE/SAND
锉平

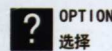

OPTION
选择

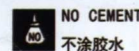

NO CEMENT
不涂胶水



DECAL
贴纸

DECAL APPLICATION

1. Cut off decal from sheet.
2. Dip the decal in tepid water 40° C for about 10 sec. and place on a clean cloth.
3. Hold the backing sheet edge and slide decal onto the model.
4. Move decal into position by wetting decal with finger.
5. Press decal gently down with a soft cloth until excess water and air bubbles are gone.

水贴纸的使用:

1. 从水贴纸上剪下印花。
2. 将印花放入温水中浸10秒, 然后放在干净布上。
3. 拿着印花纸板将印花移到模型上。
4. 手指蘸水将印花移到适当的位置。
5. 用软布轻压印花直至不干, 汽泡消失。

Parts

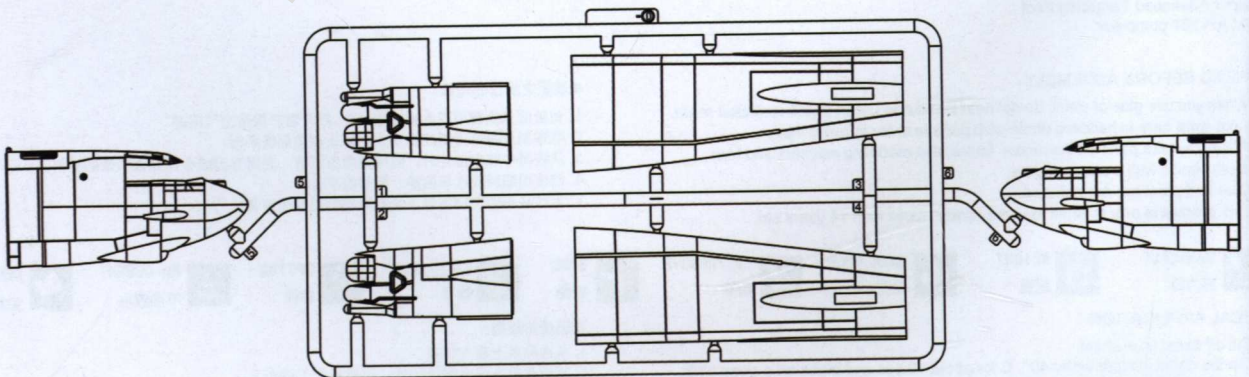
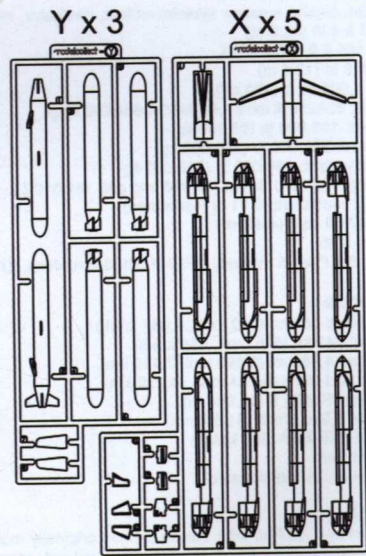
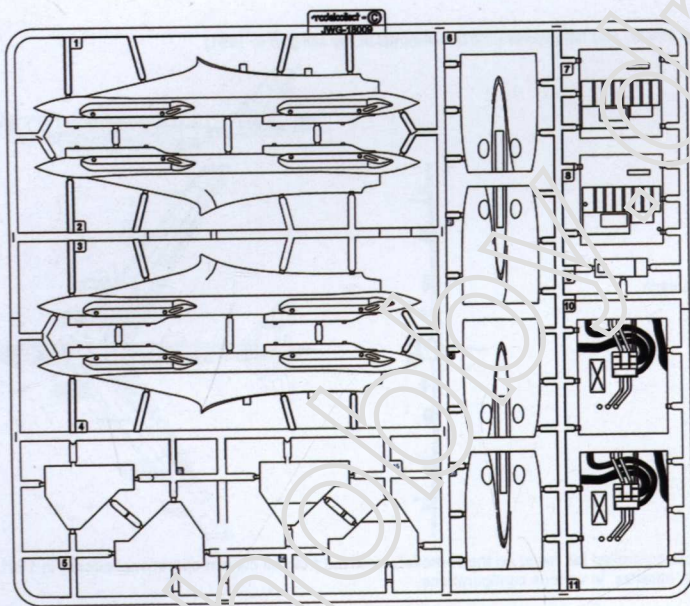
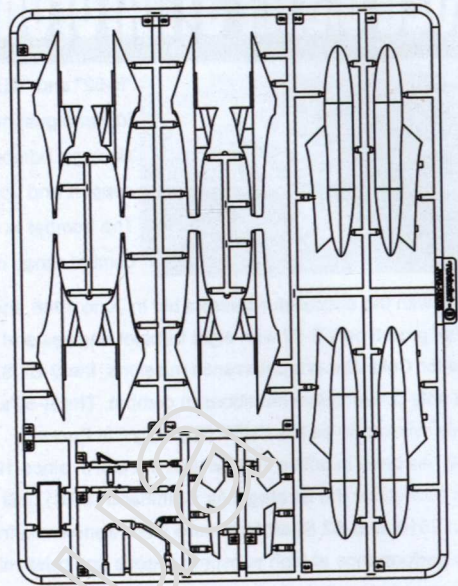
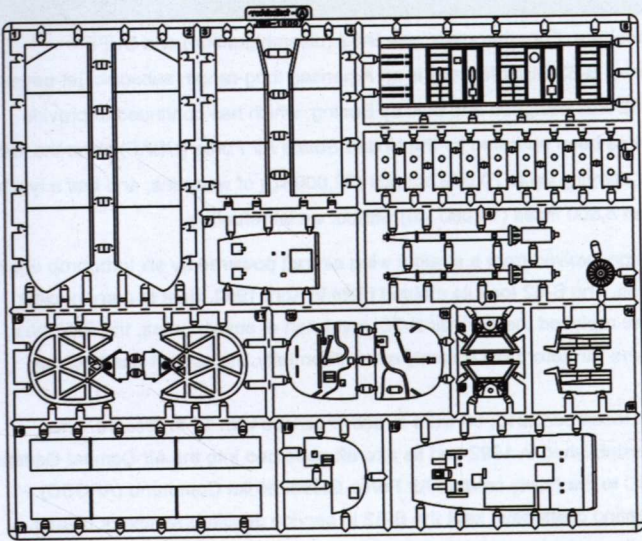

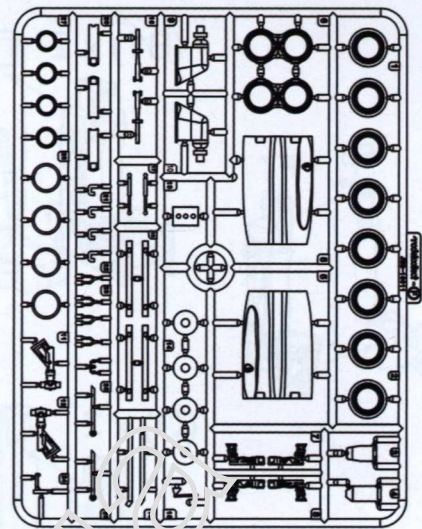
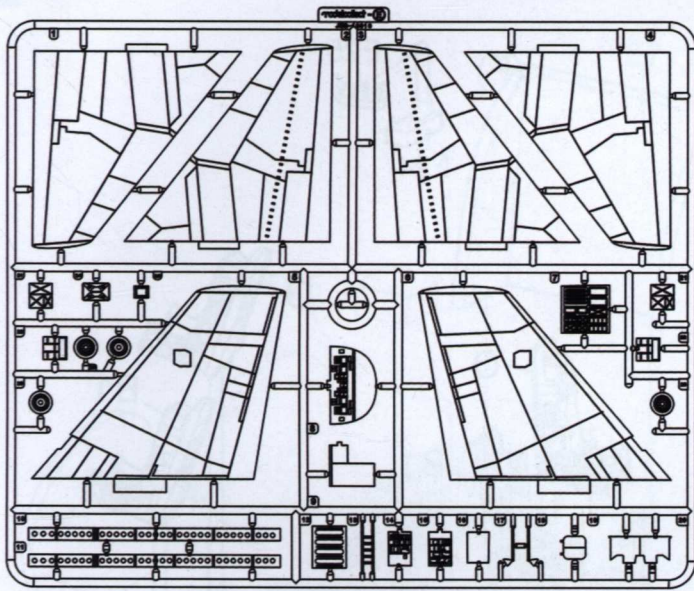

F x 2



N1

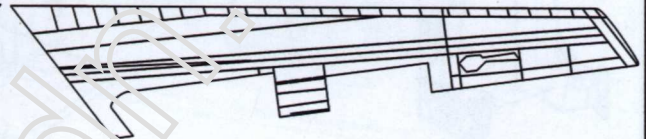

N2

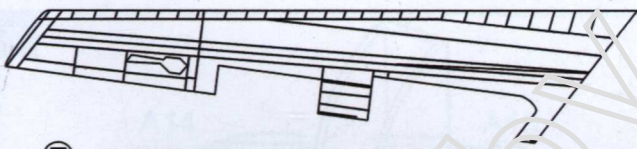

R1

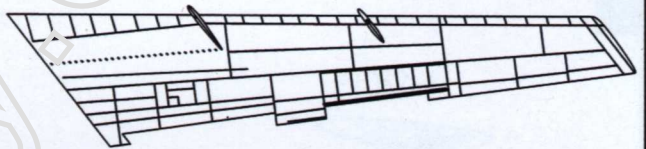

R2

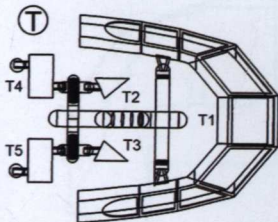

T

T4

T5

T3

T2

T1

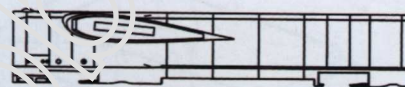

N3



R3

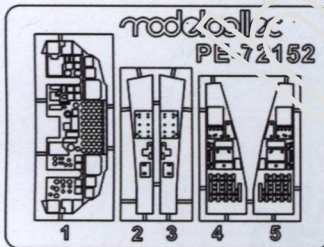

rodcollect
PE-72152

1

2

3

4

5

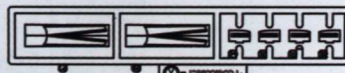

X x 5



X x 5

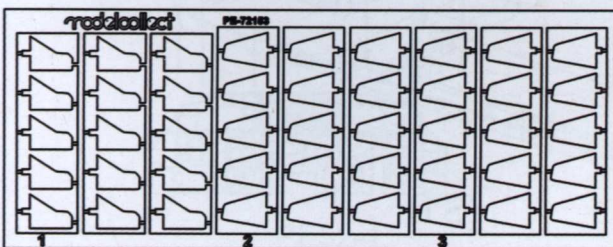

rodcollect

PE-72188

1

2

3

4

5

6

7

8

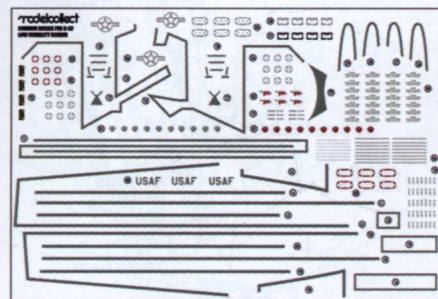

rodcollect

USAF USAF USAF

rodcollect

6492

6492

6492

6492

6492

6492

6492

6492

6492

6492

6492

6492

6492

6492

6492

6492

6492

6492

6492

1

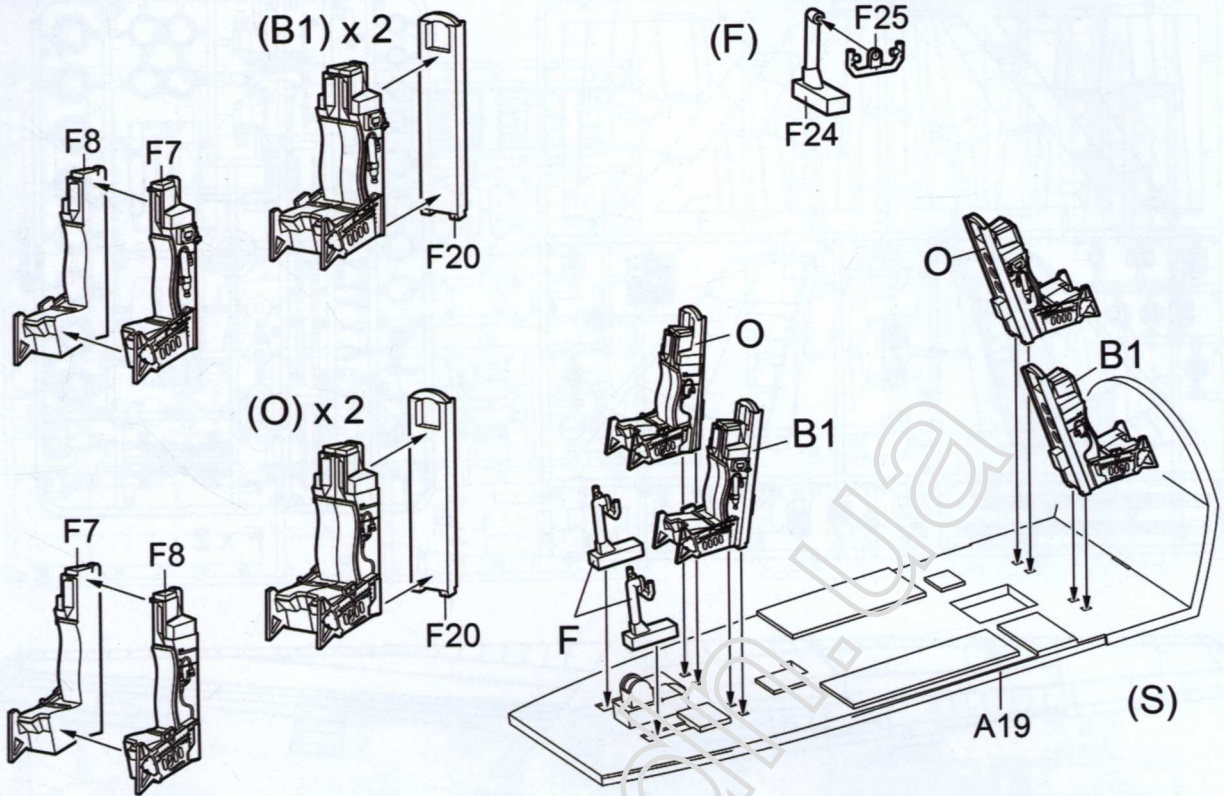

2

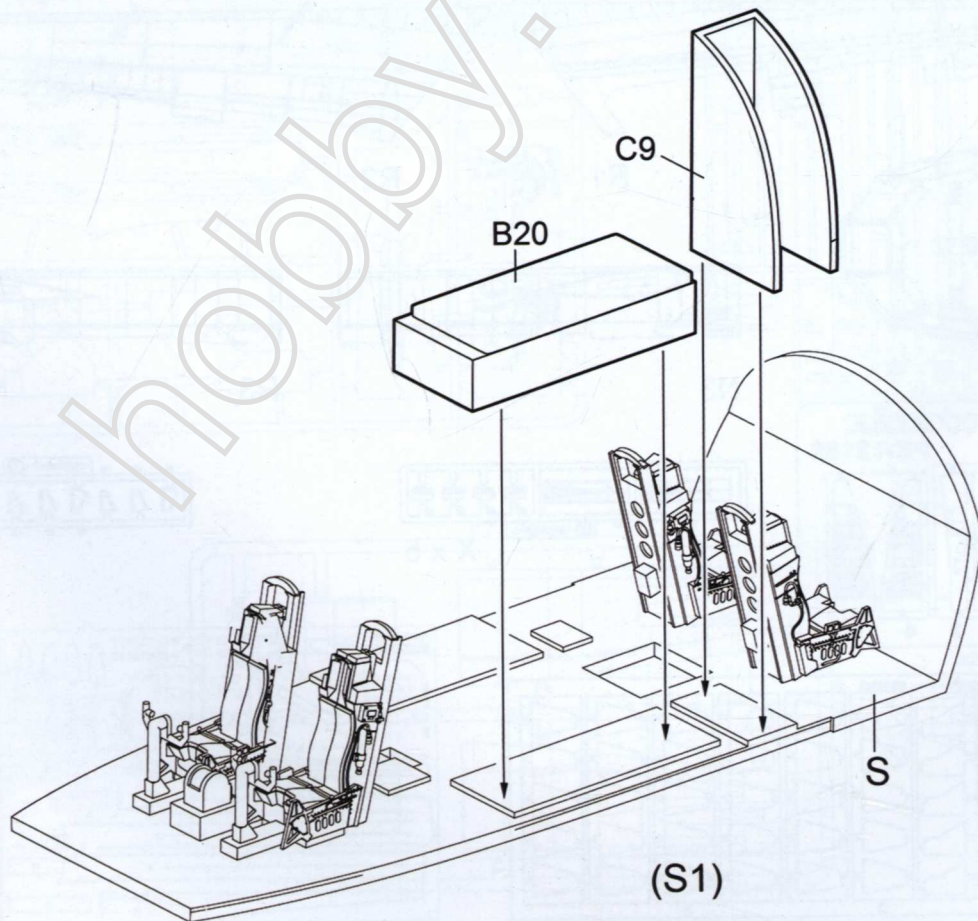

3

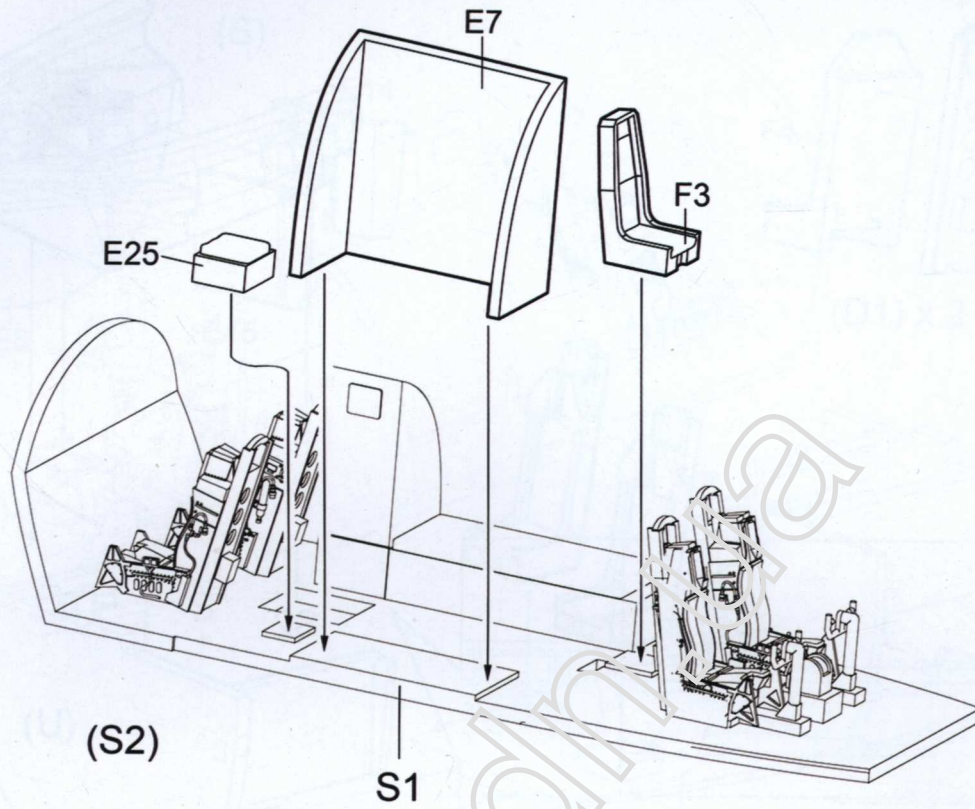

4

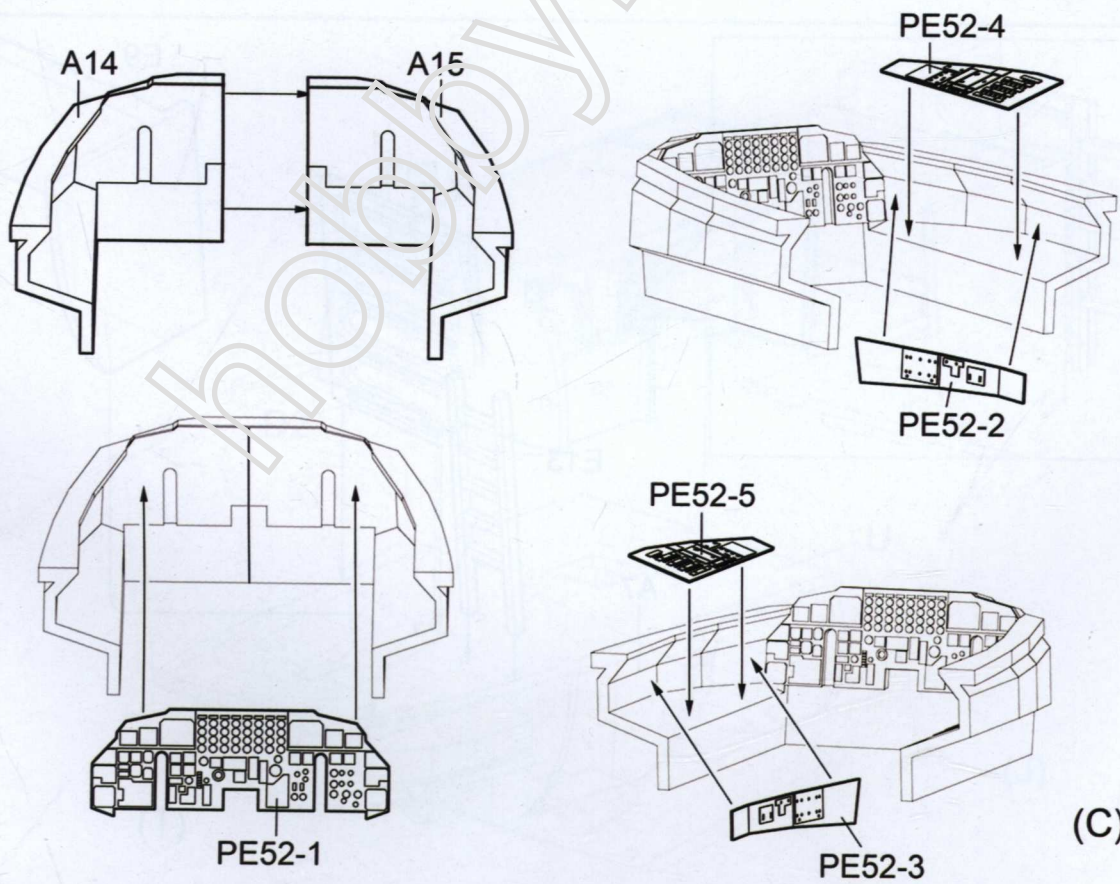

5

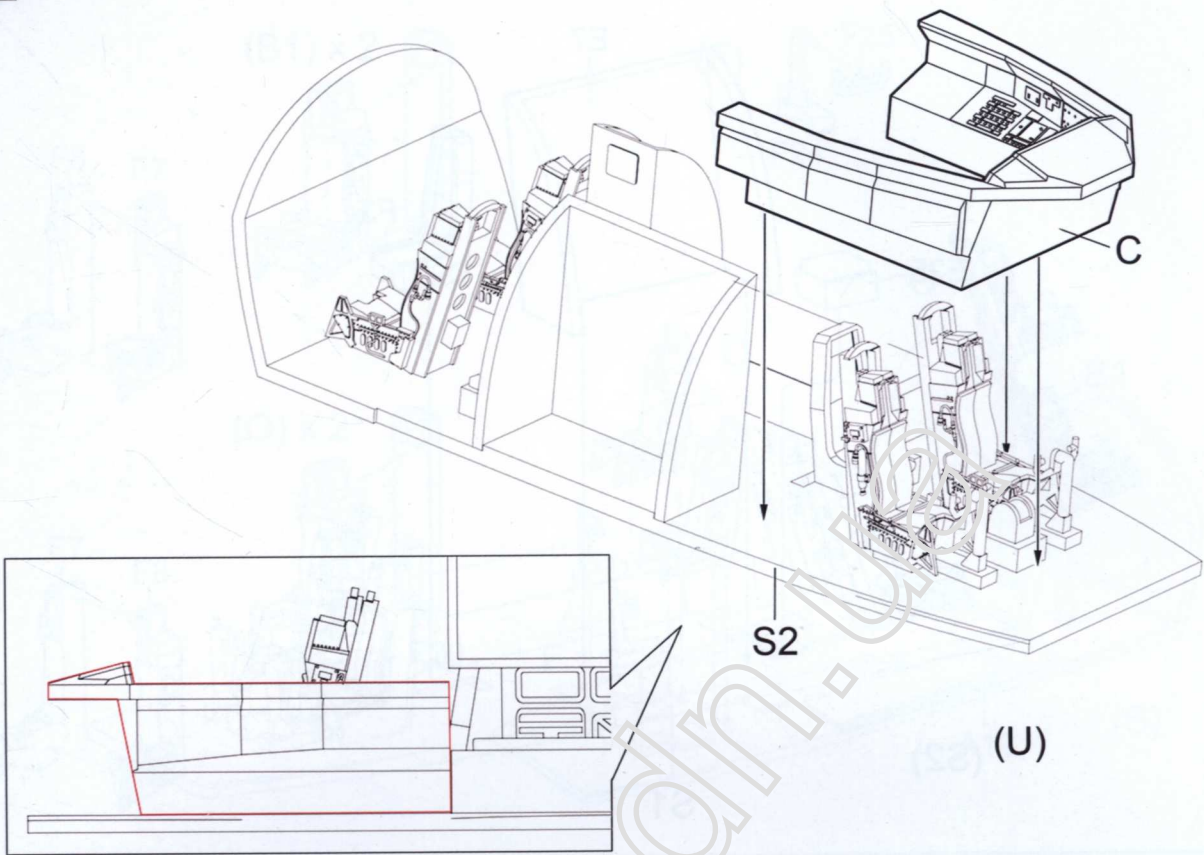

6

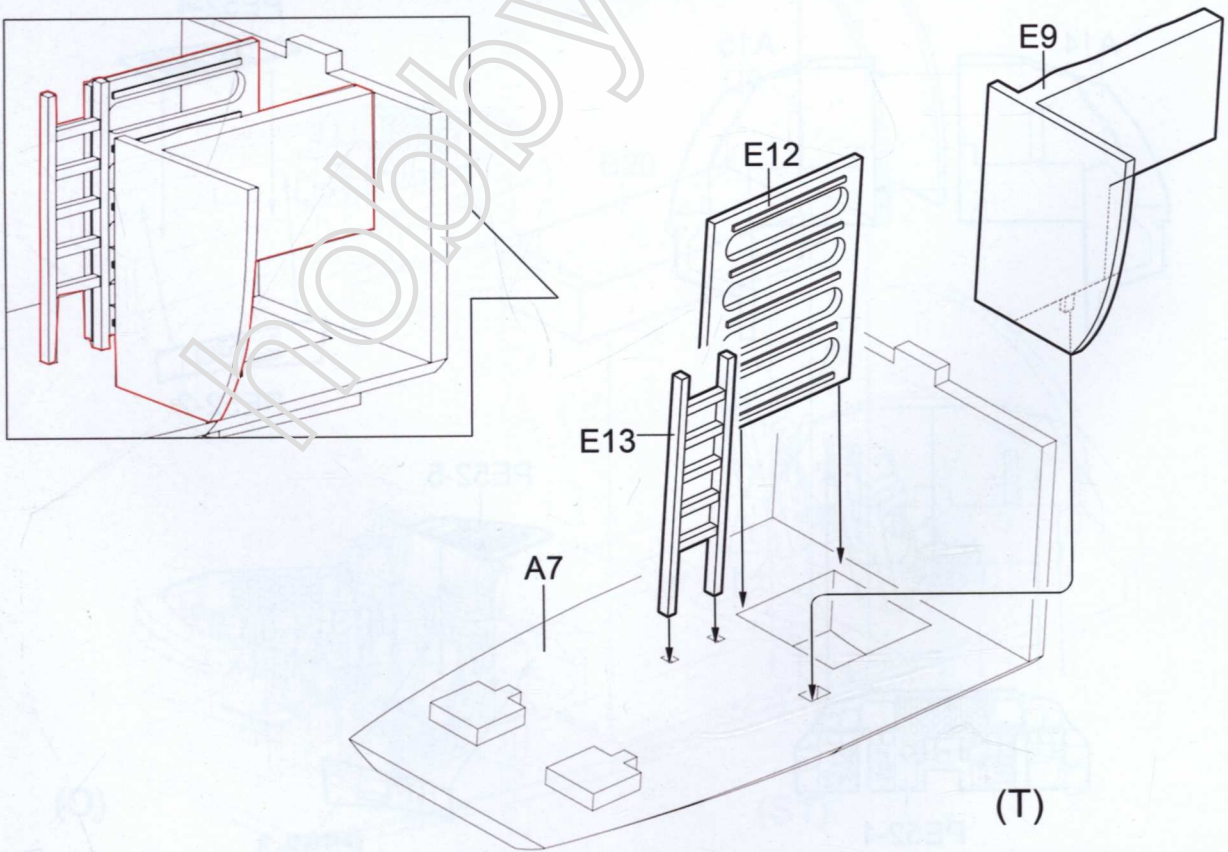

7

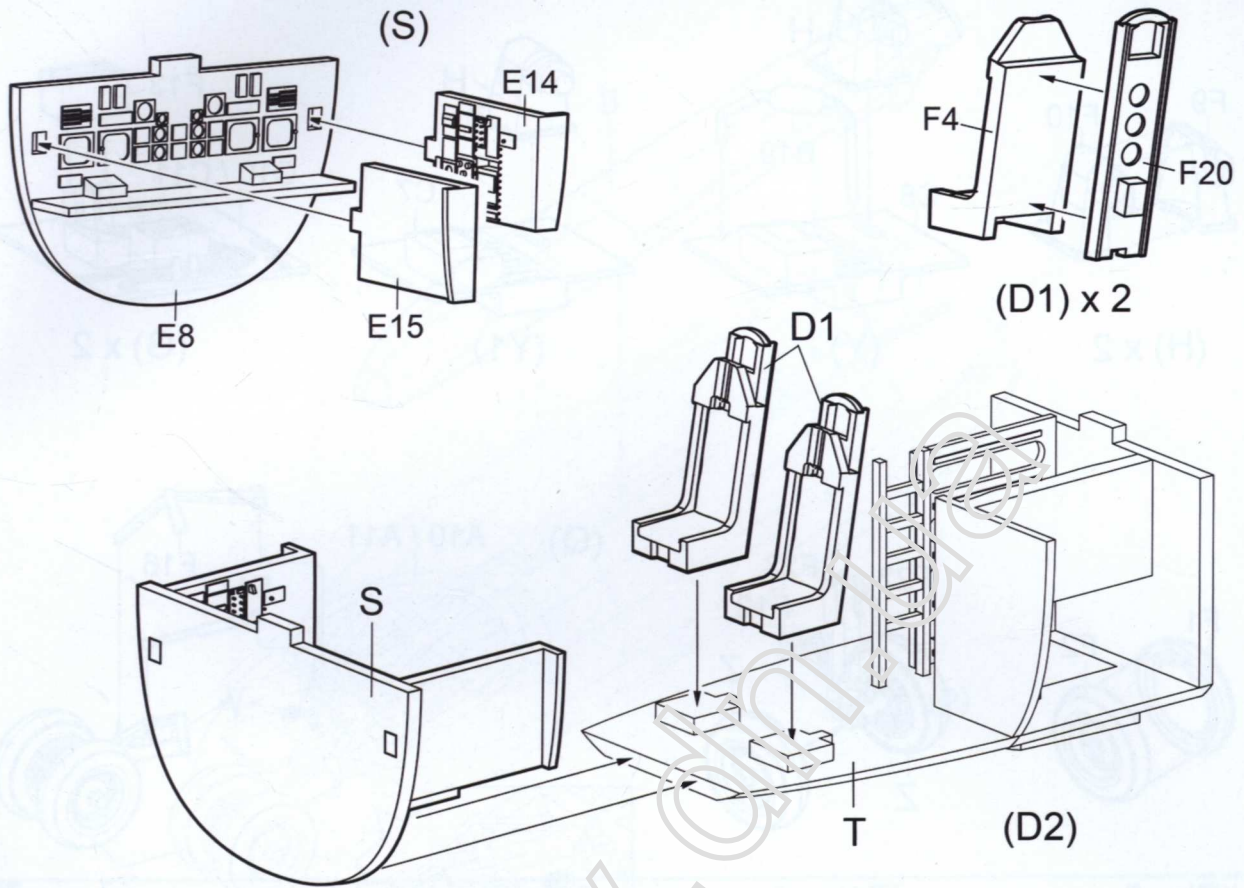

8

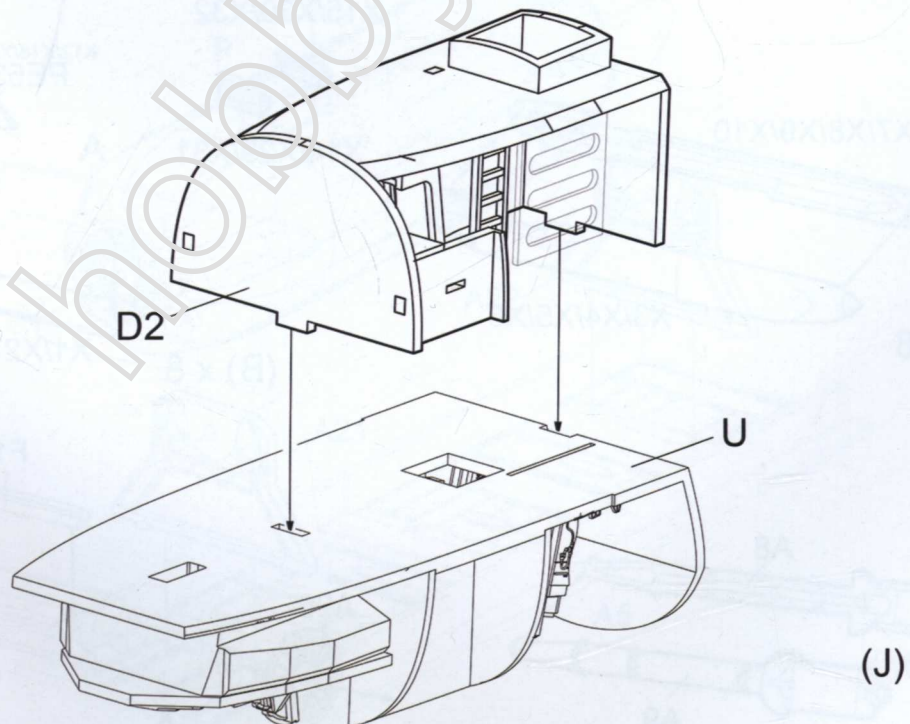

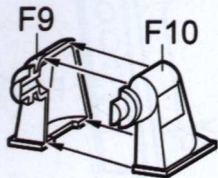

(H) x 2

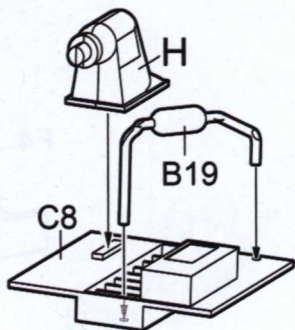

(Y)

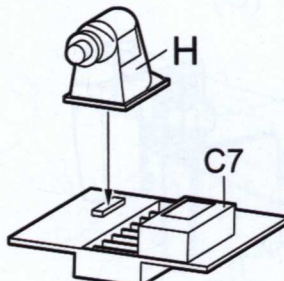

(Y1)

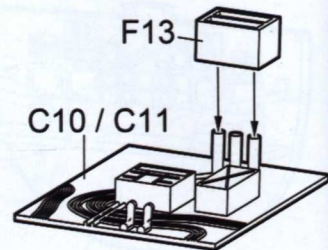

(G) x 2

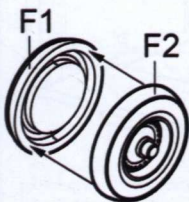

(Z) x 8

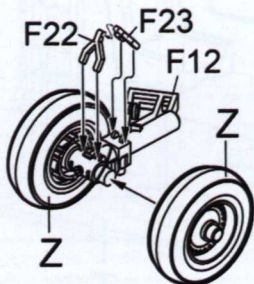

(Z1) x 4

(Q)

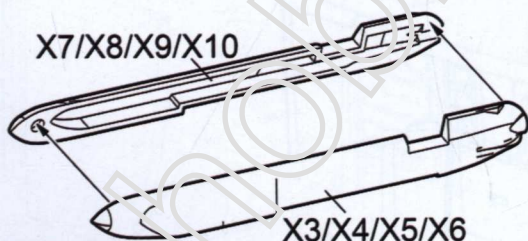
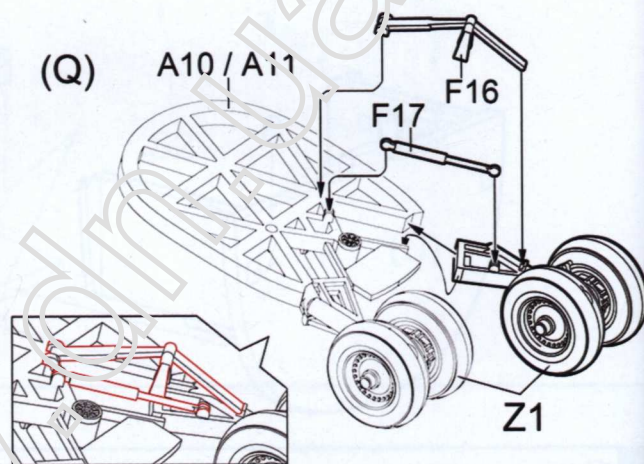

(A) x 8

X15/X30/X32



X14/X29/X31

X12/X18/X21/X25

PE53-2

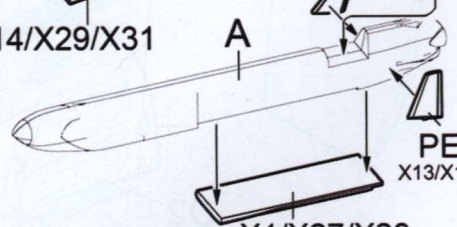

(B) x 8

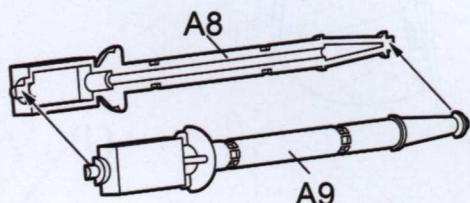

(X)

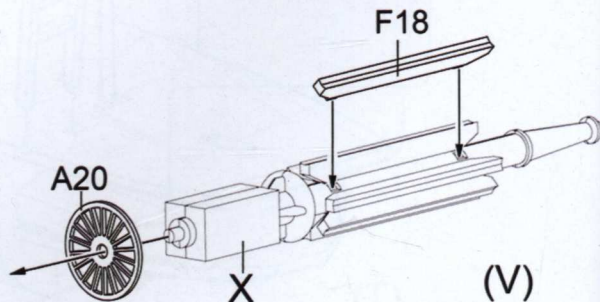

(V)

11

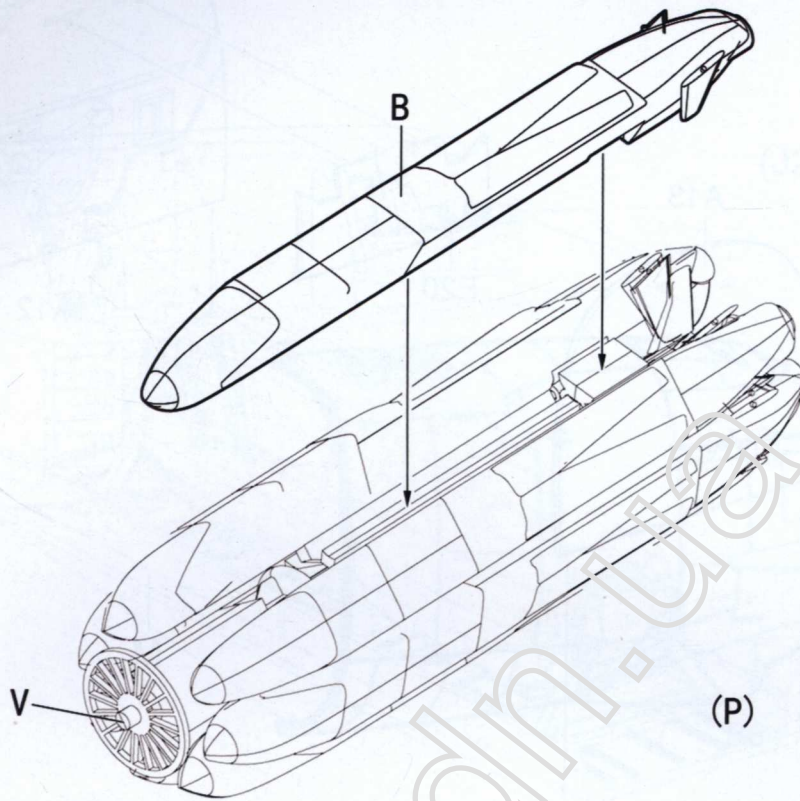

12

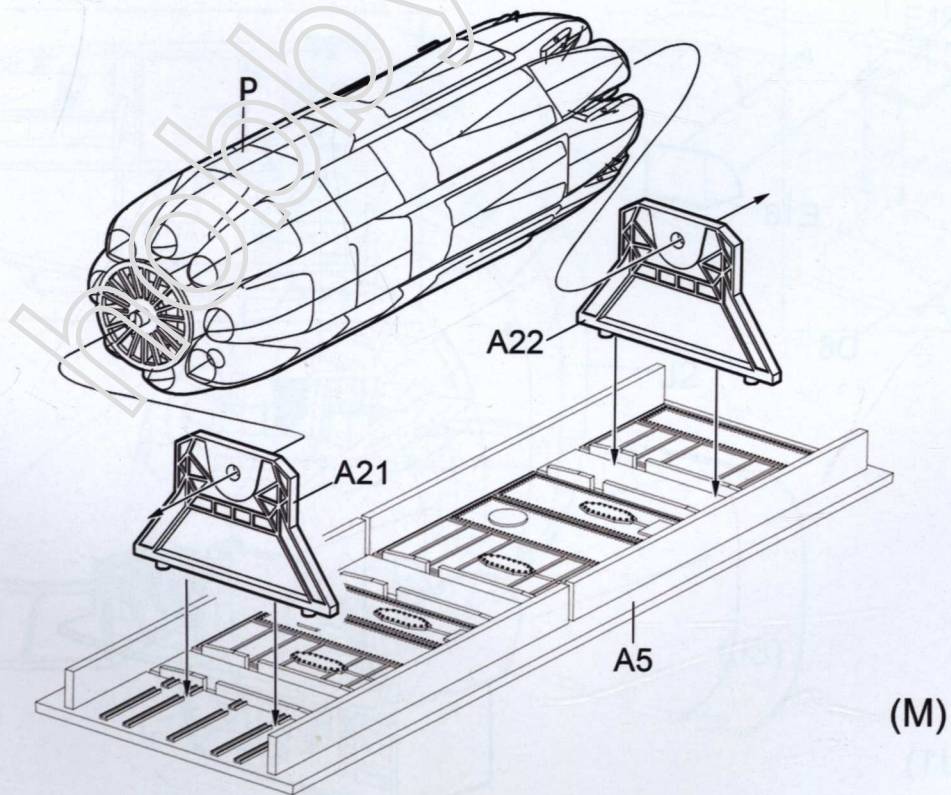

13

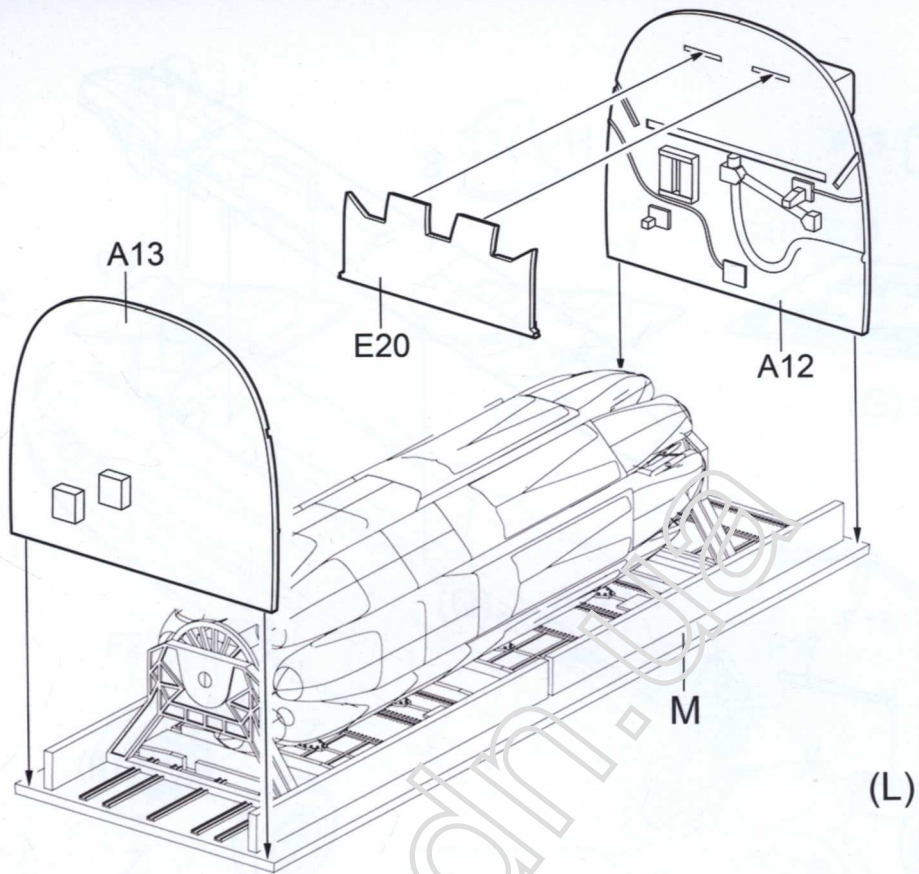

14

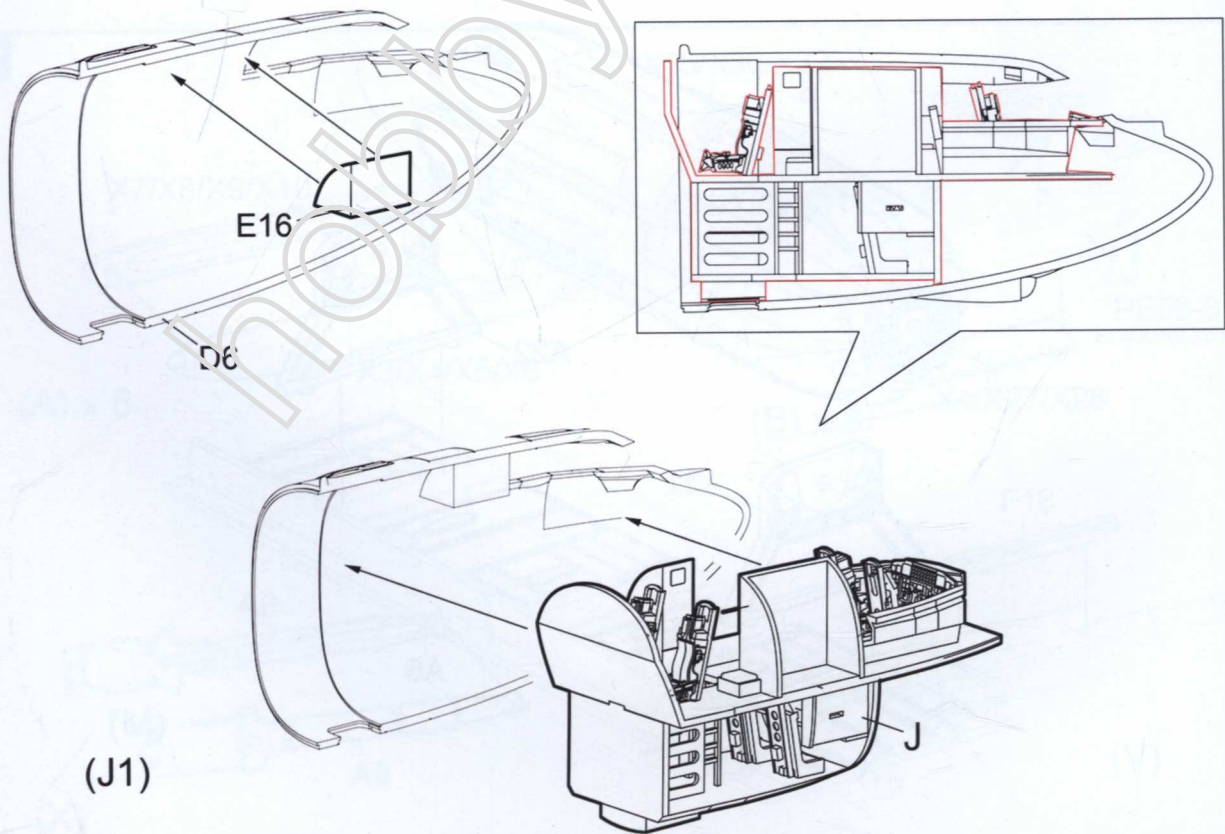

15

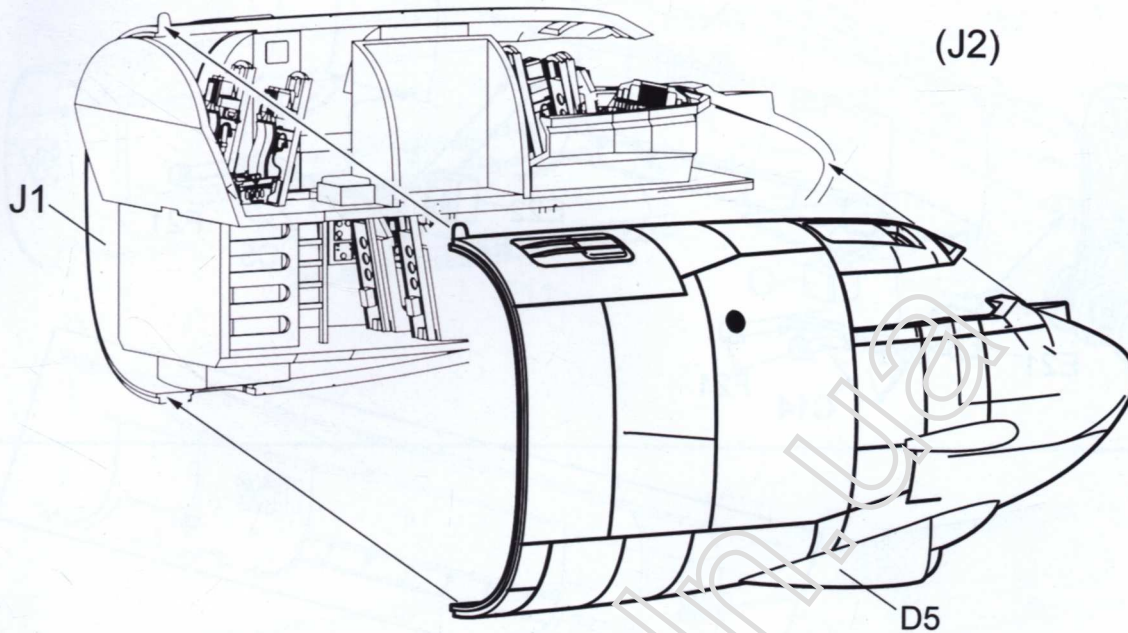

16

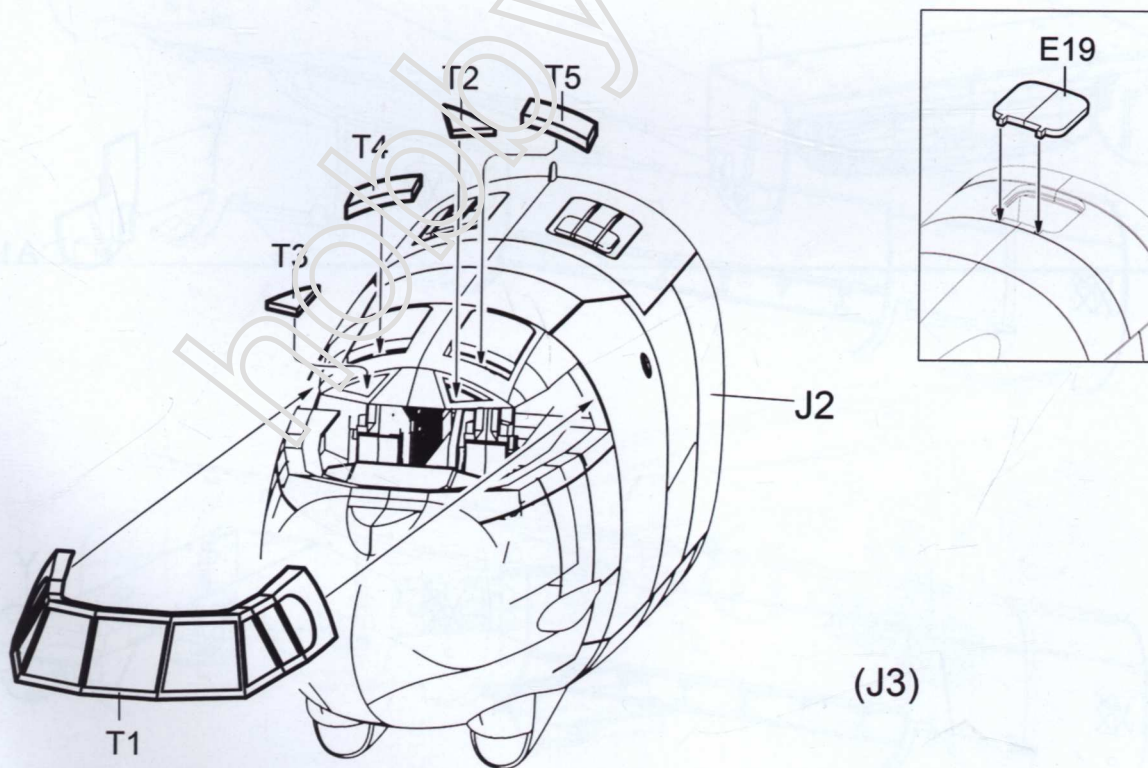

17

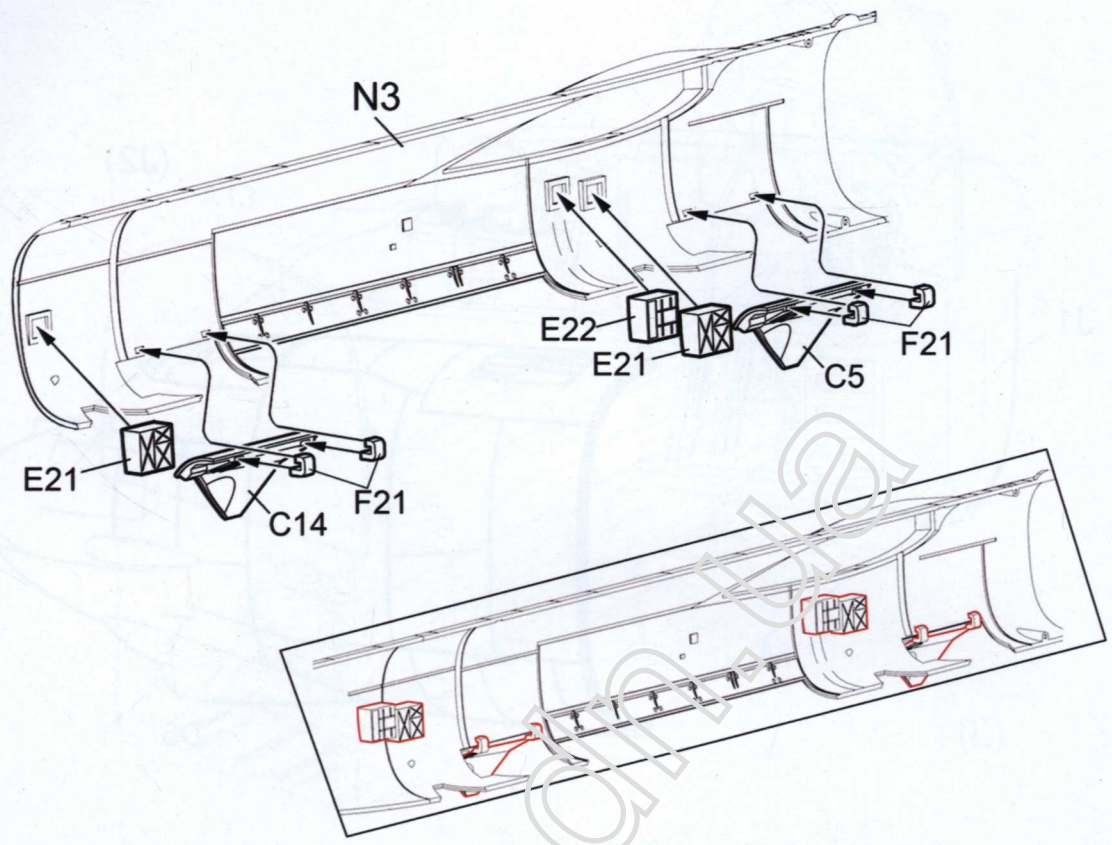

18

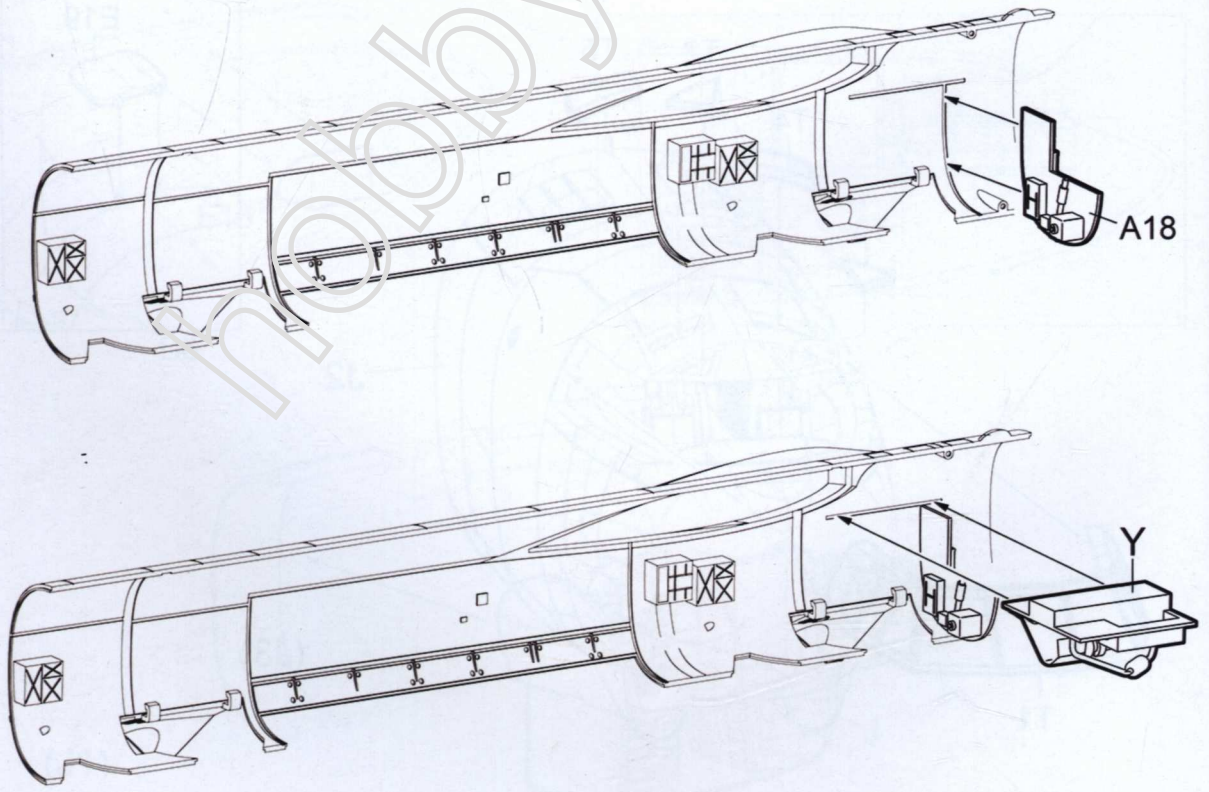

19

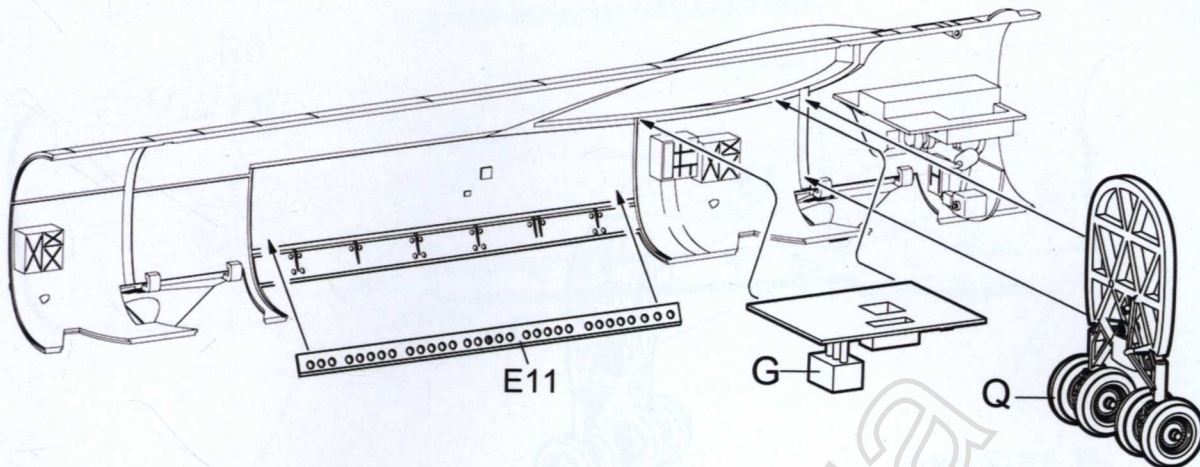

20

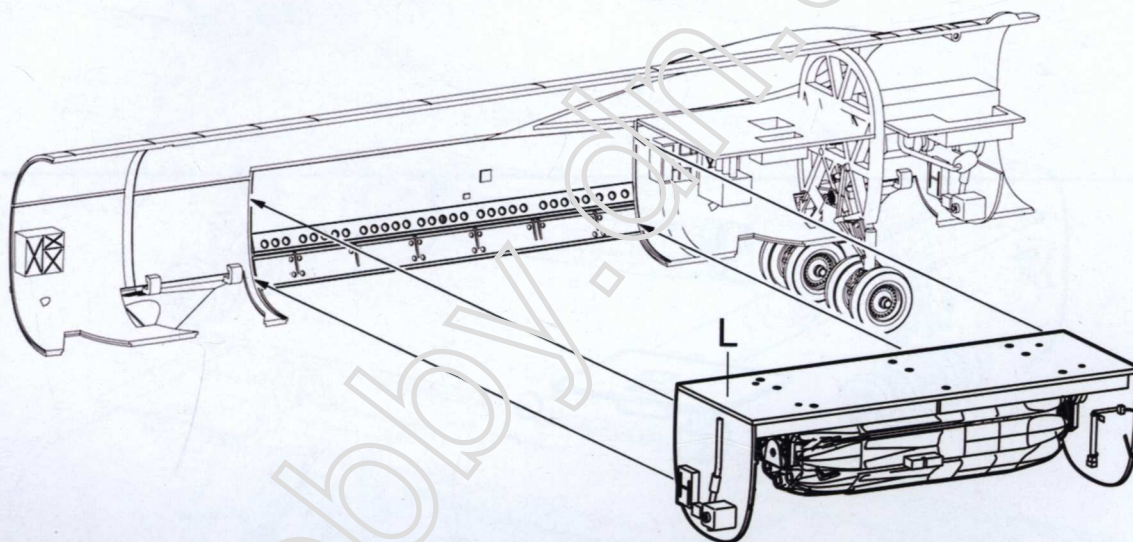

21

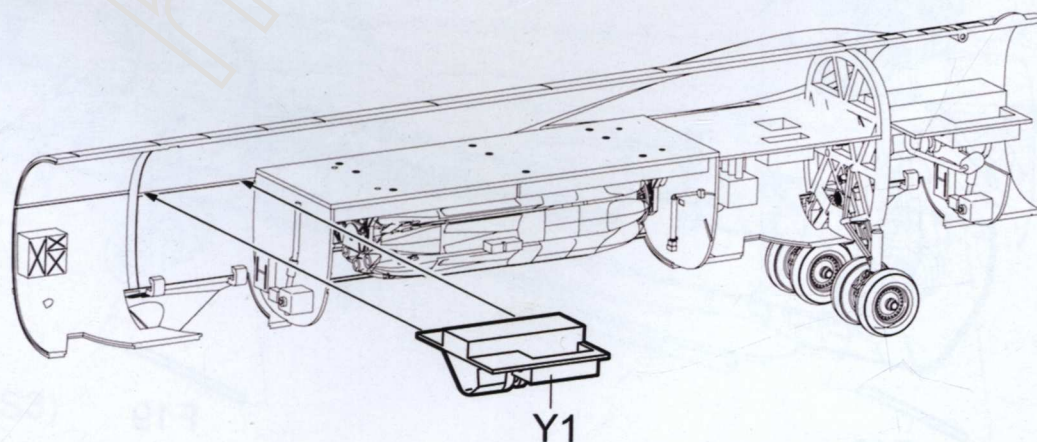

22

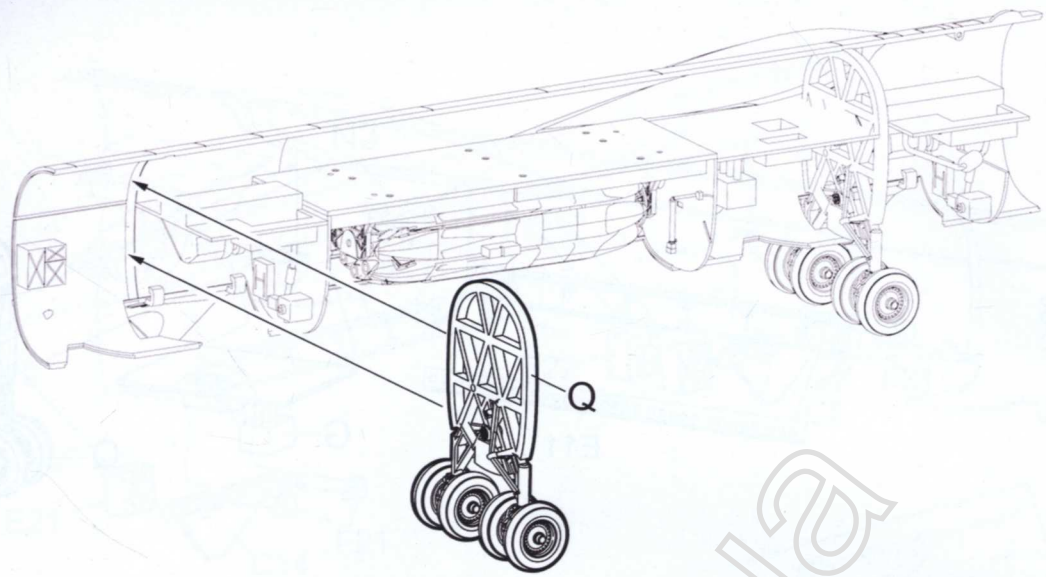

23

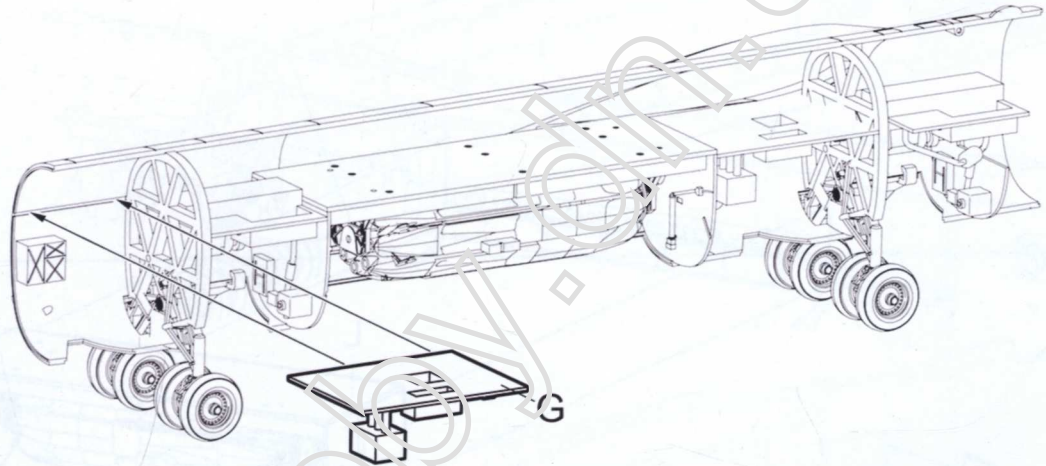

24

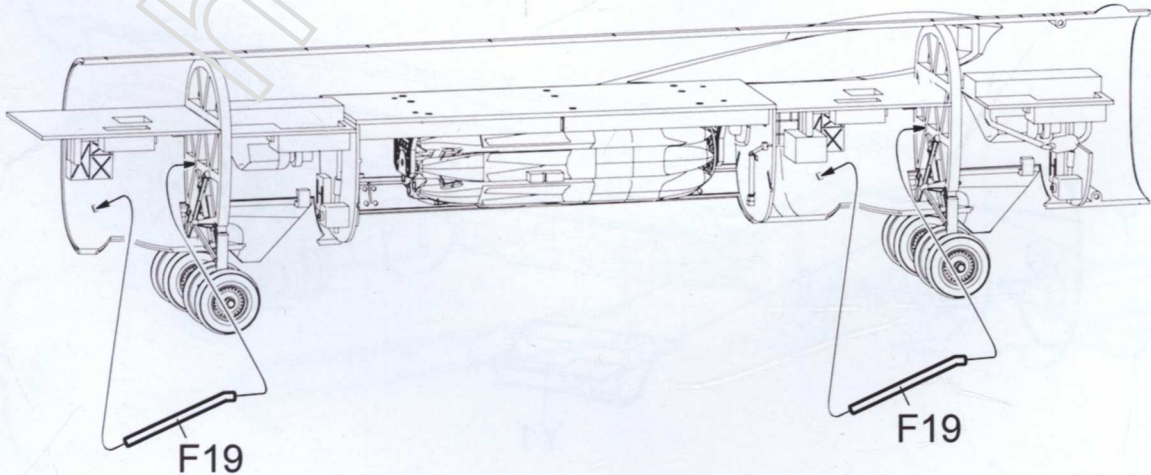

25

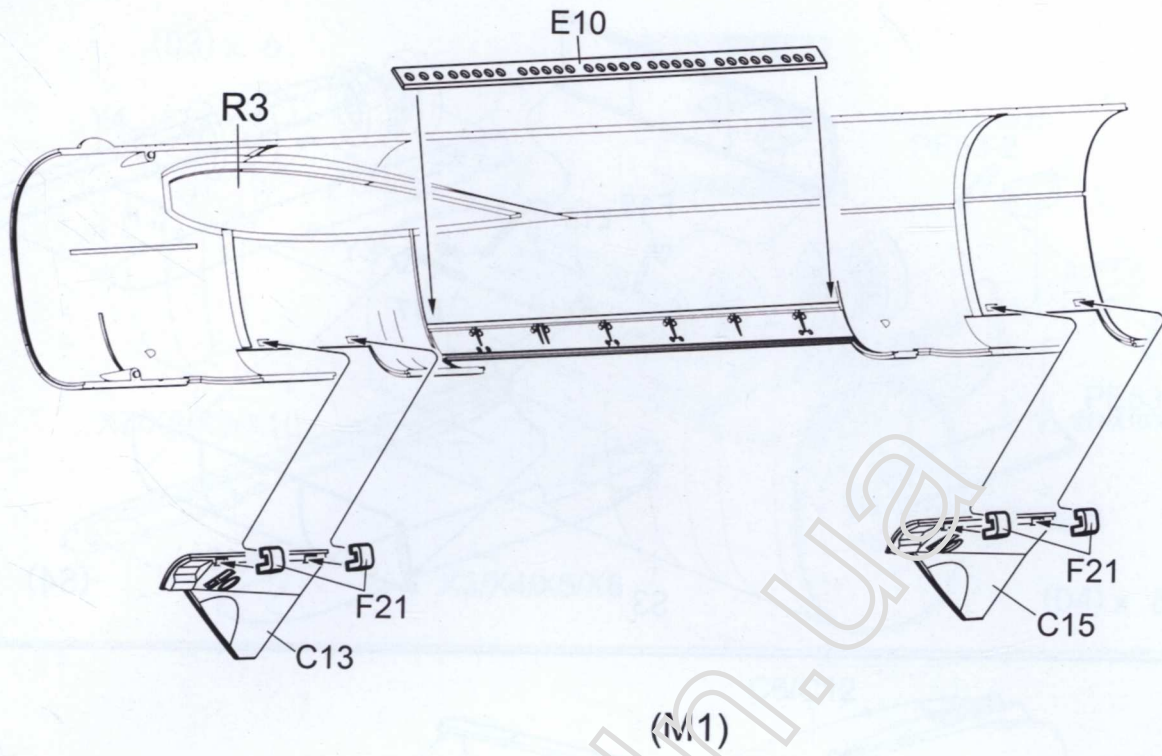

26

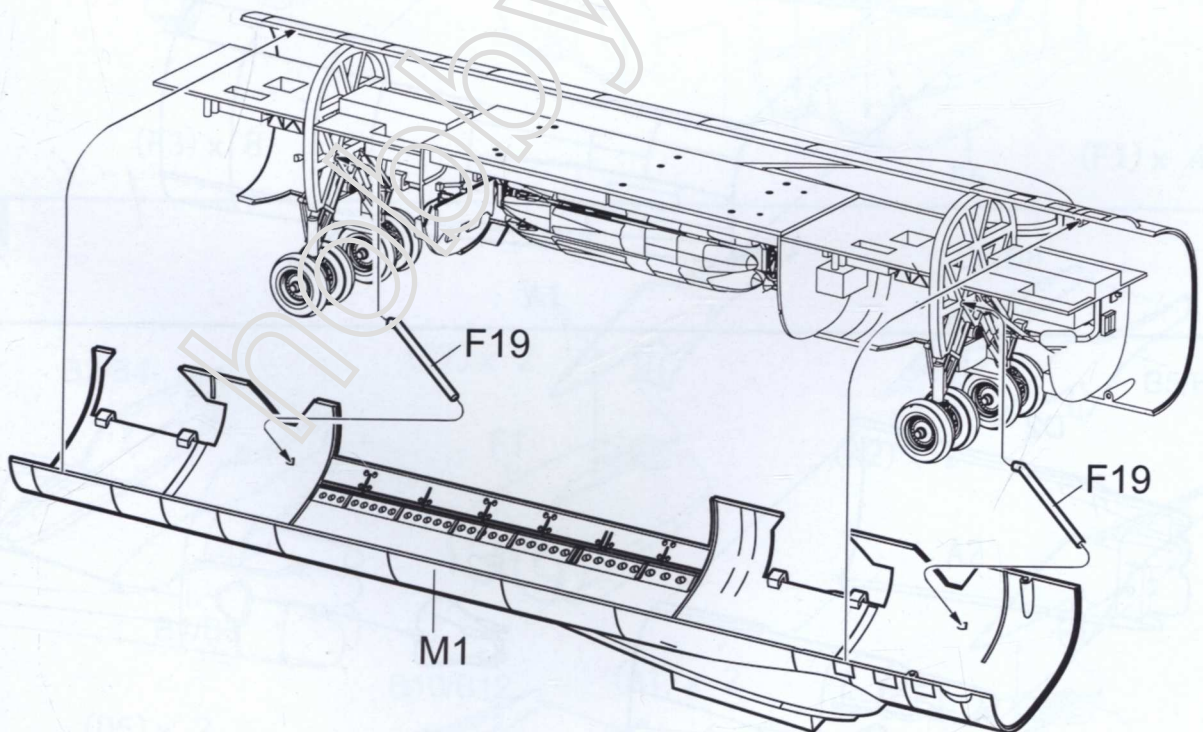

(S3)

27

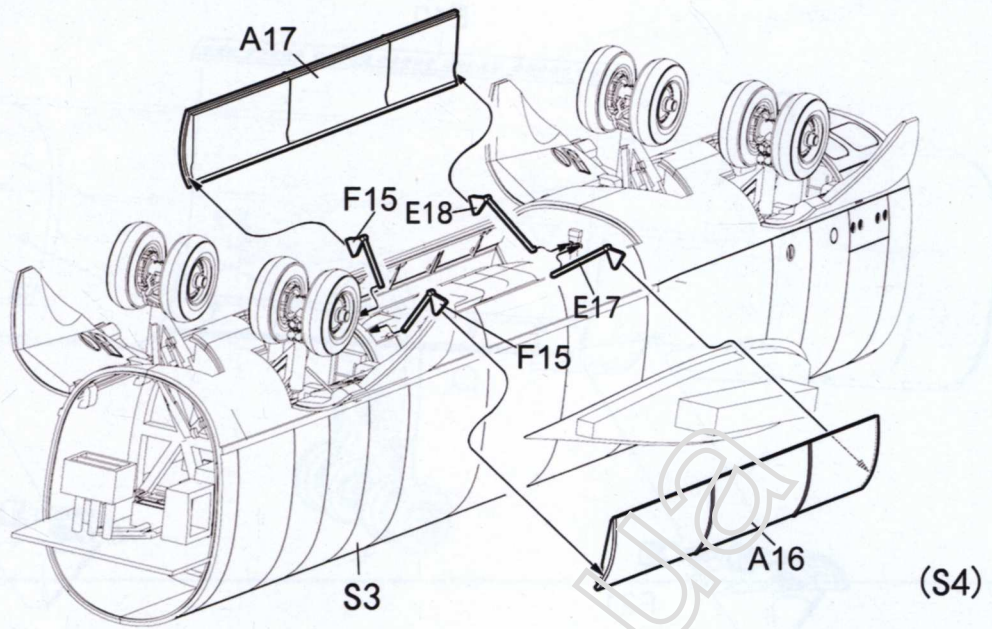

28

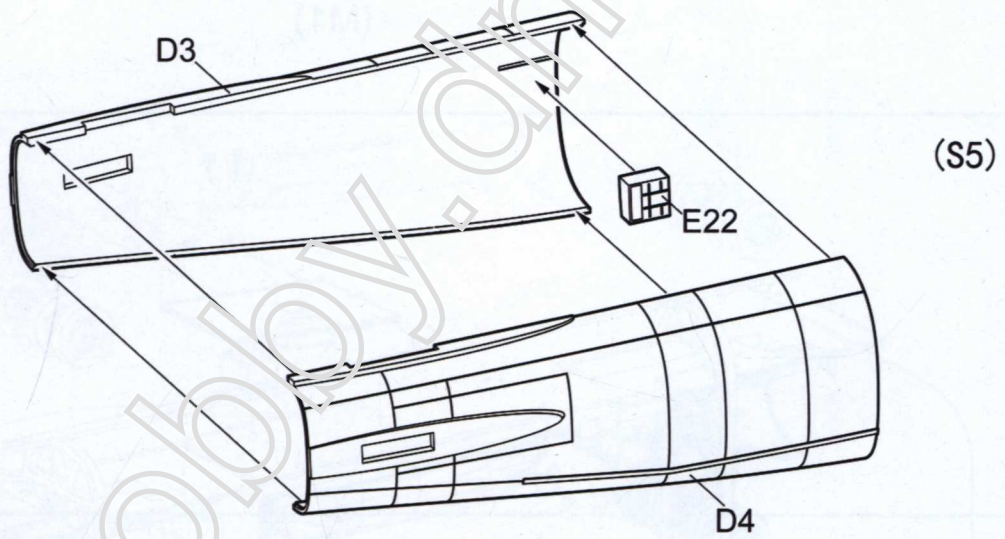

29

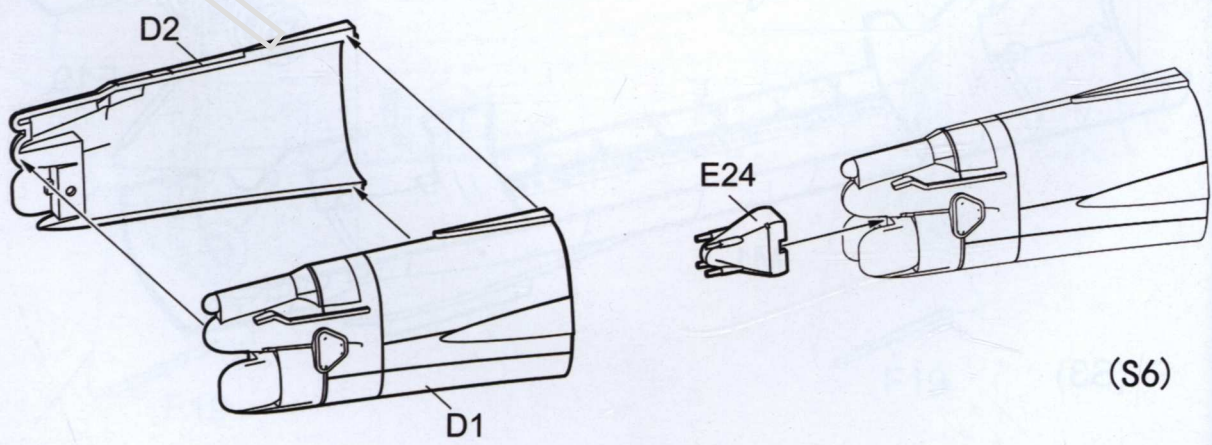

30

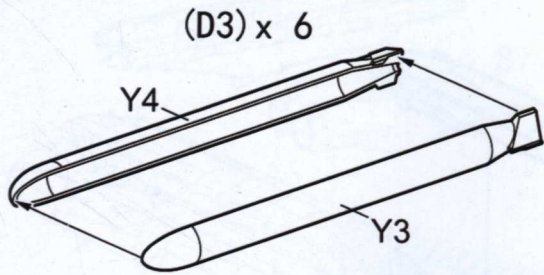

X15/X30/X32

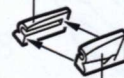

X14/X29/X31

X12/X18/X21/X25

PE53-2

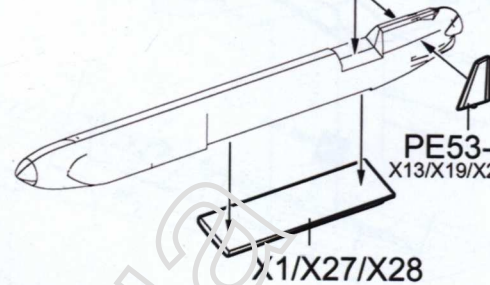
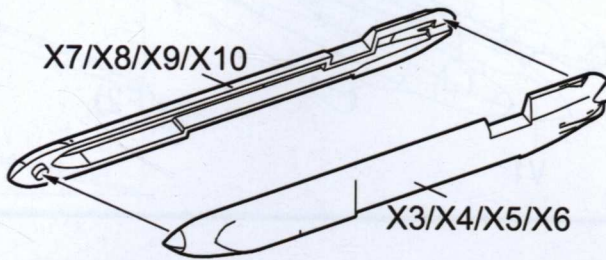

(D4) x 6

31

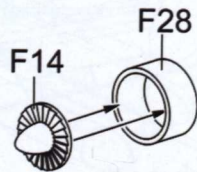

(F3) x 8

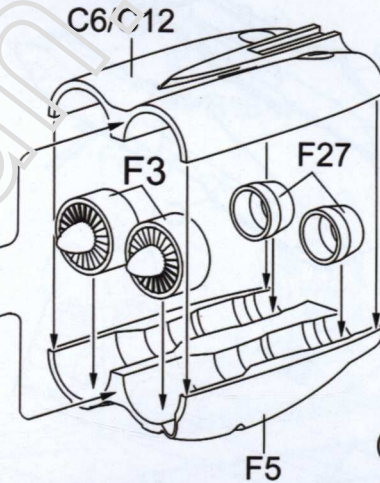

(F1) x 4

32

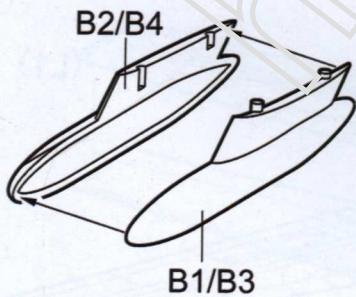

(D5) x 2

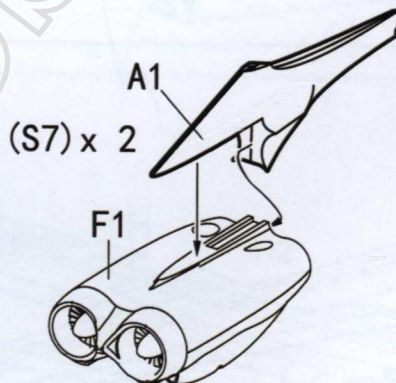

(S7) x 2

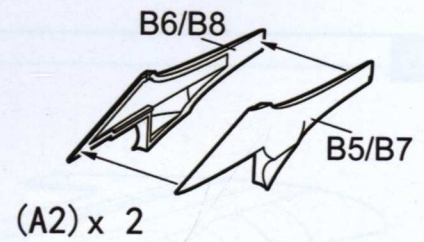

(A2) x 2

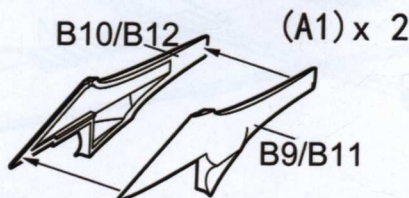

(A1) x 2

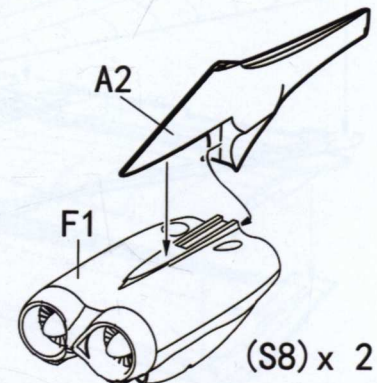

(S8) x 2

33

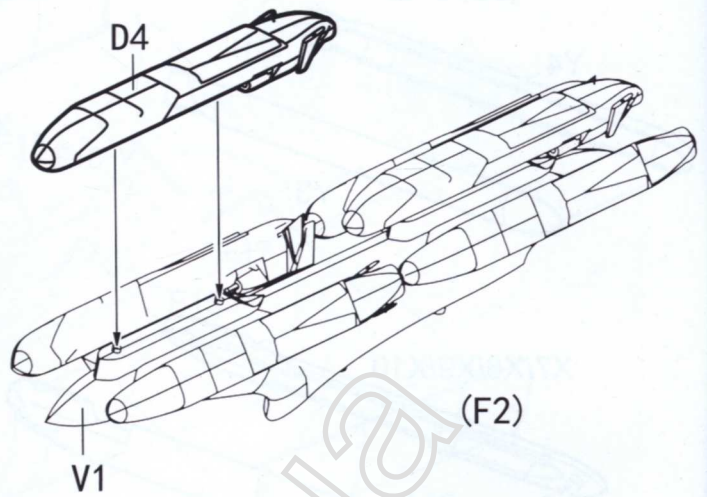
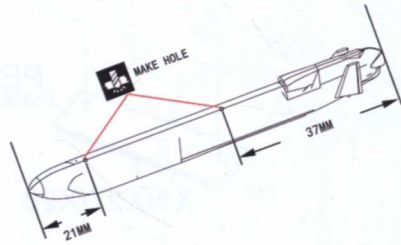
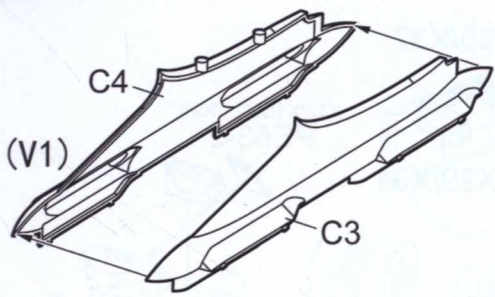

34

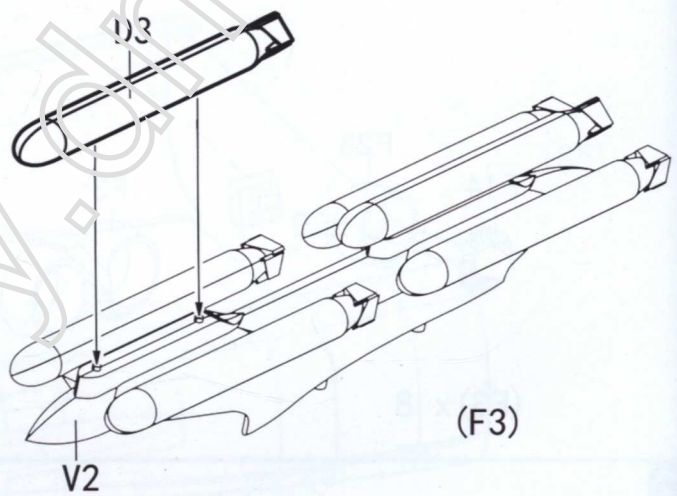
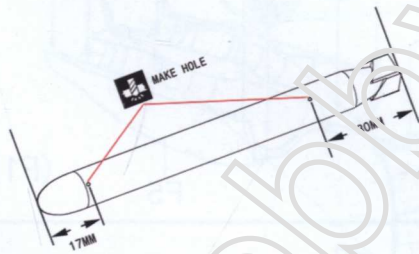
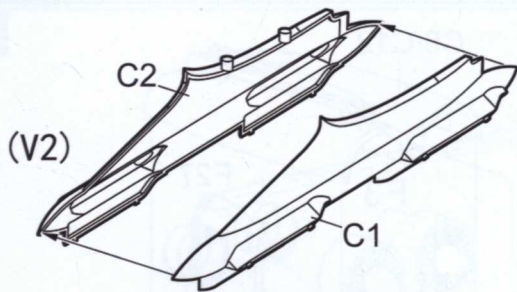

35

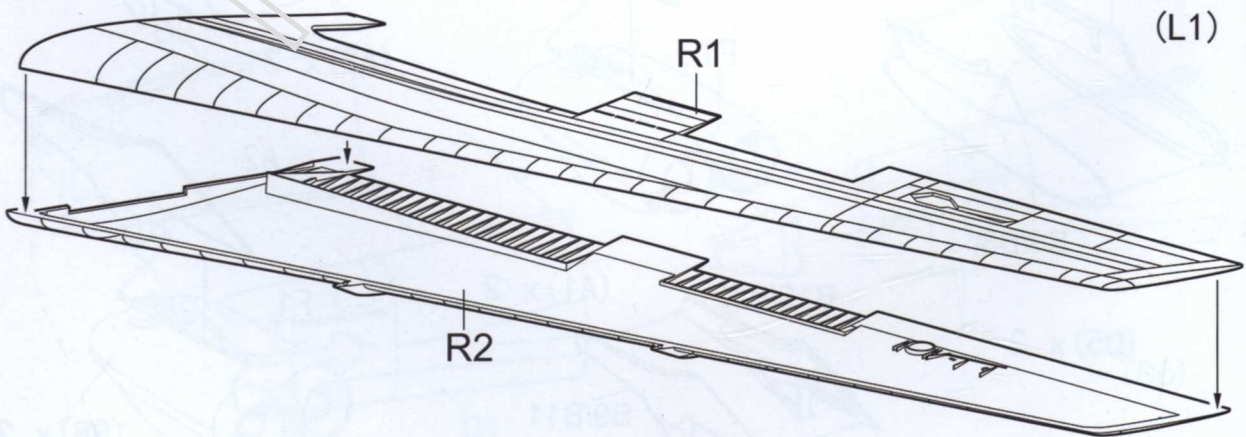

36

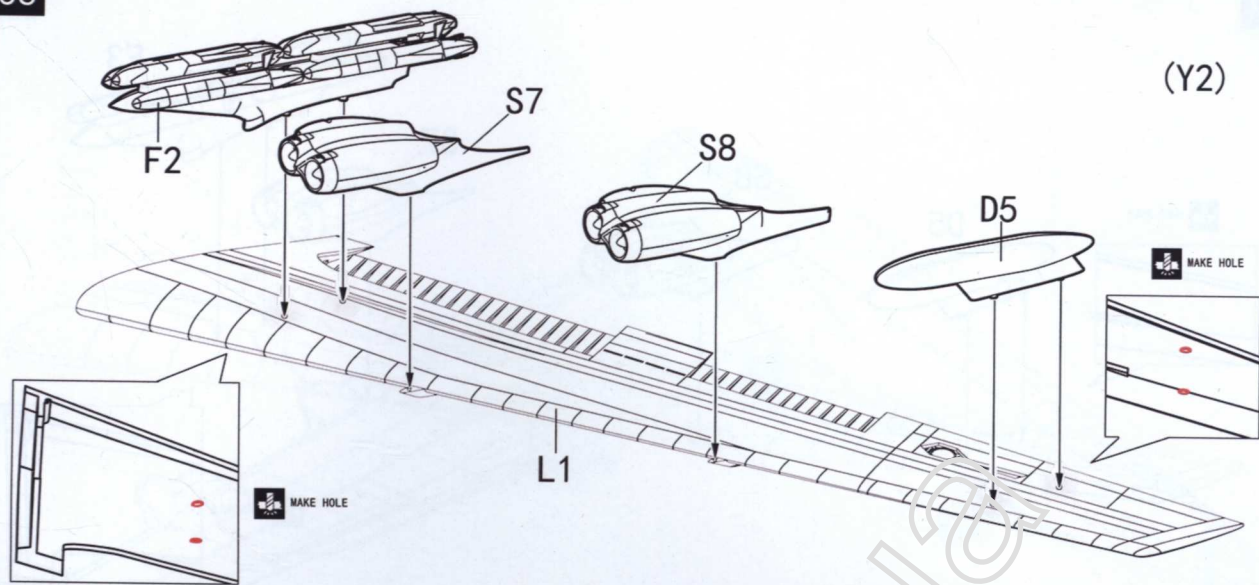

37

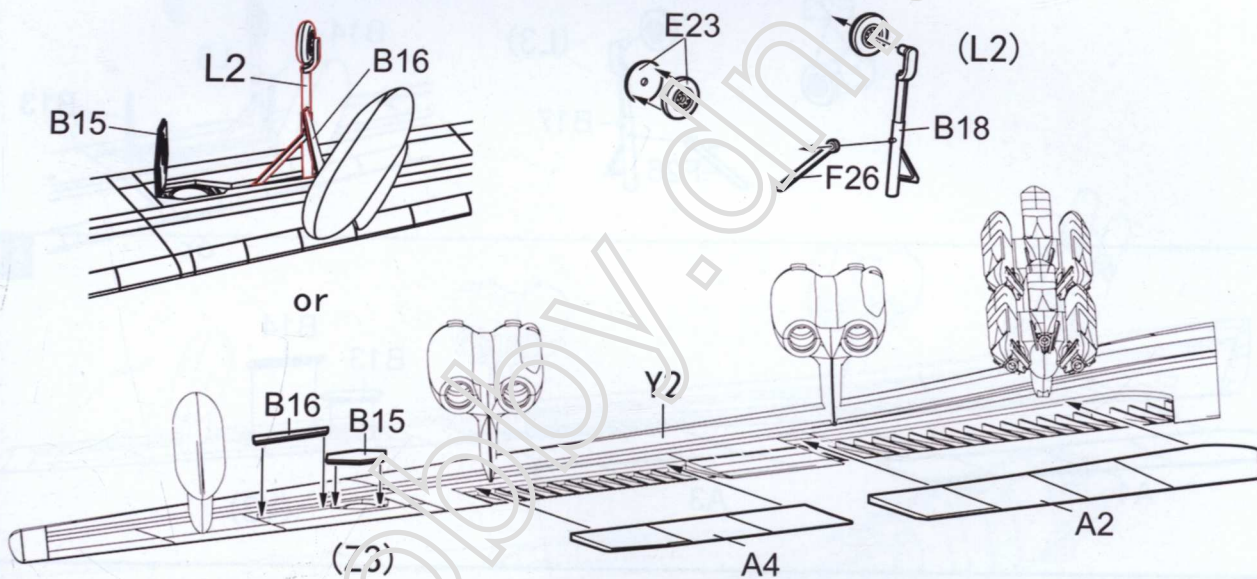

38

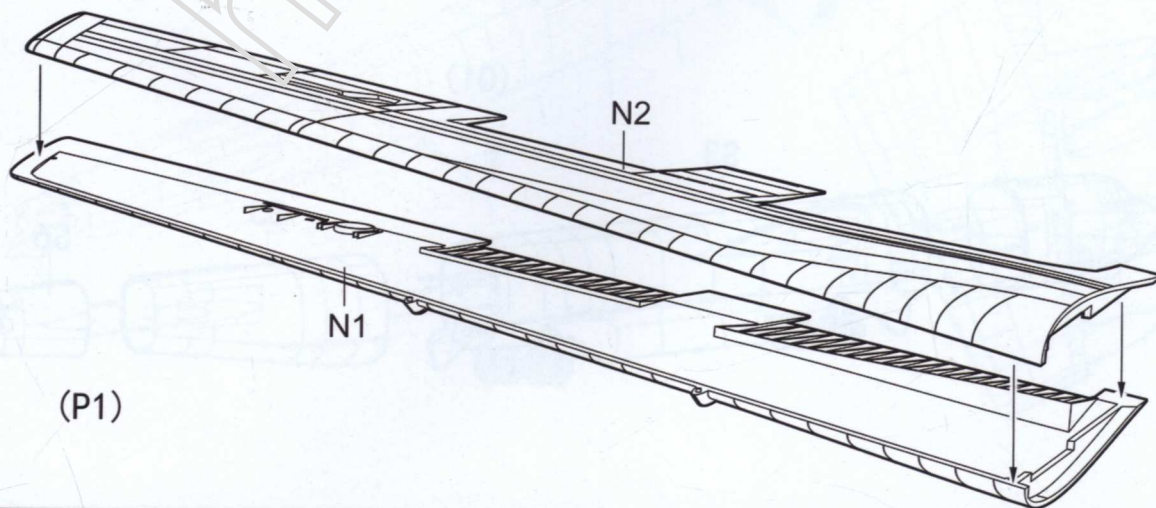

39

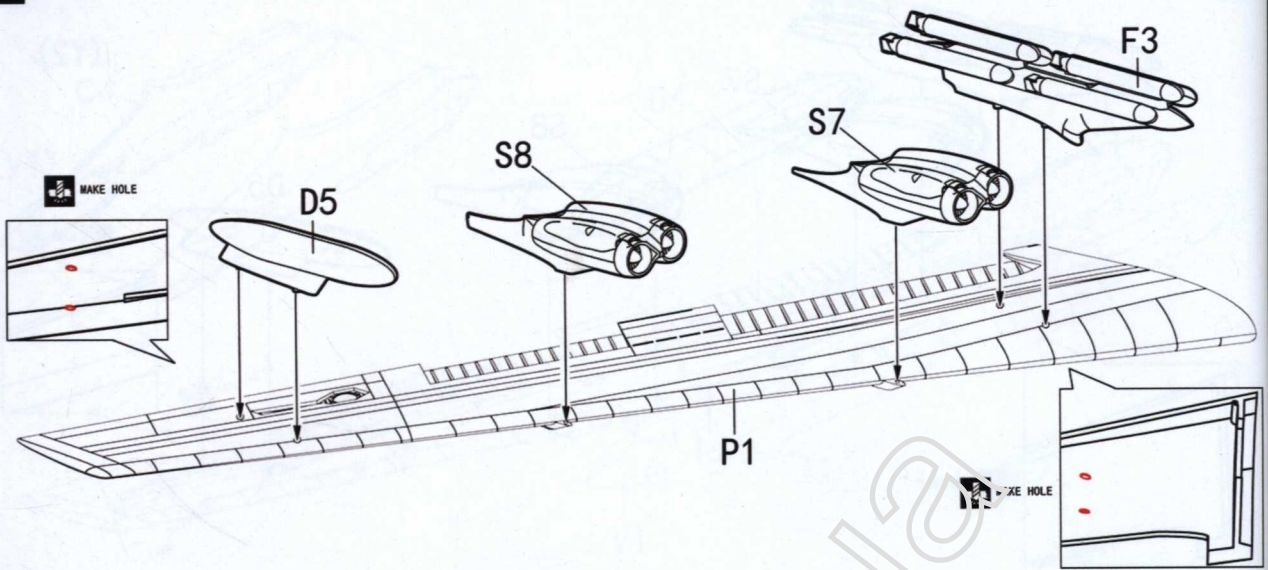

40

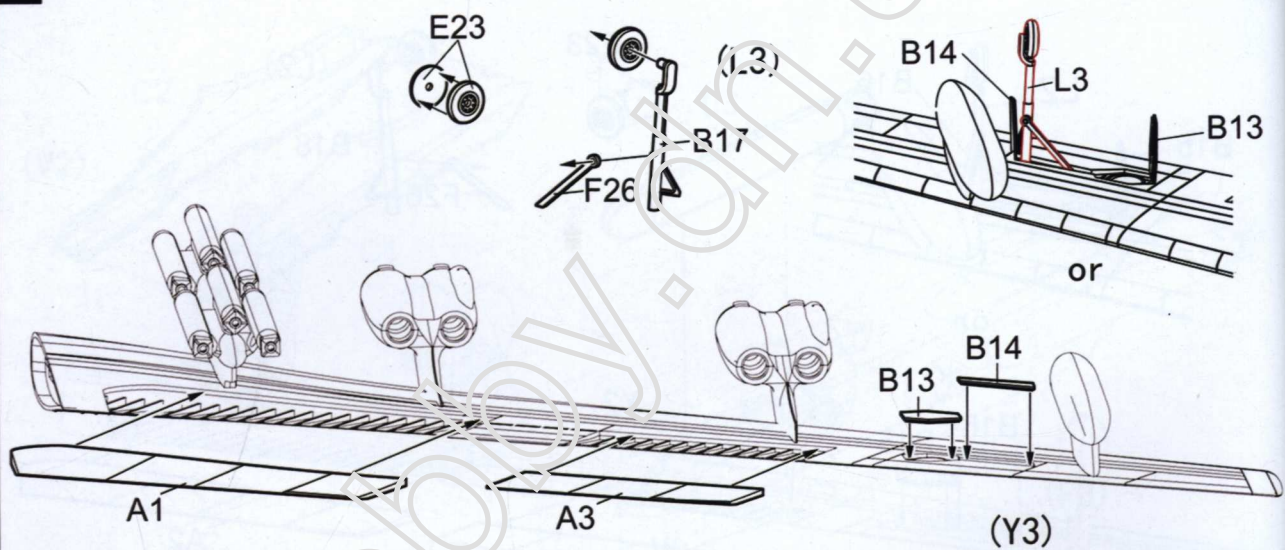

41

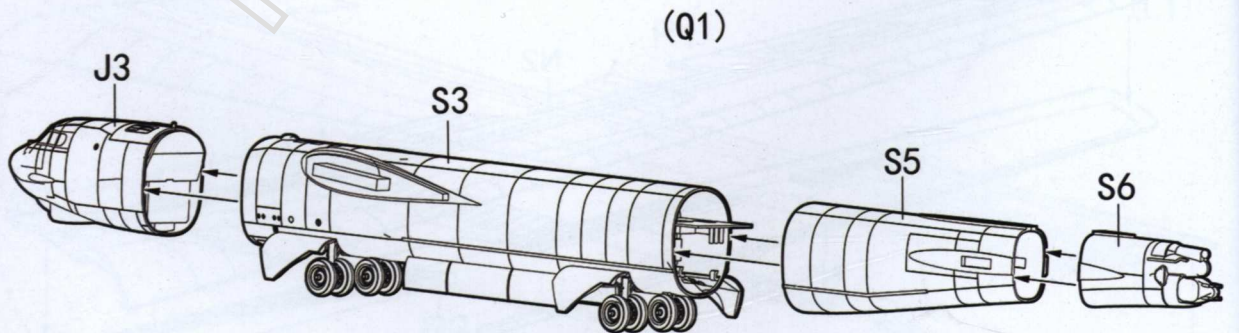

42

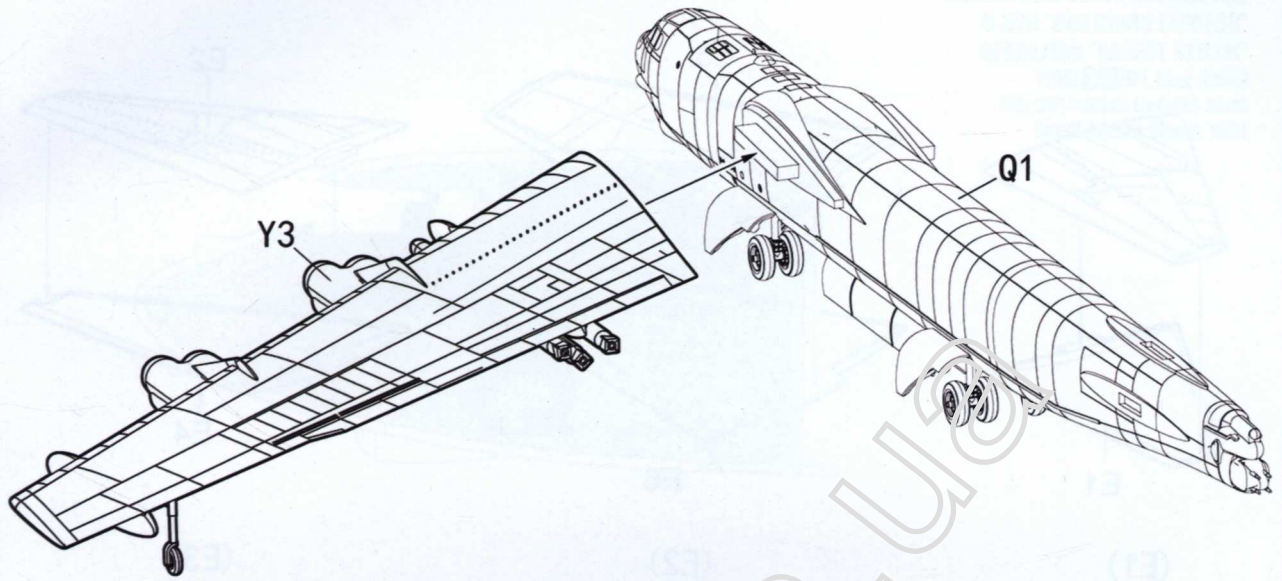

43

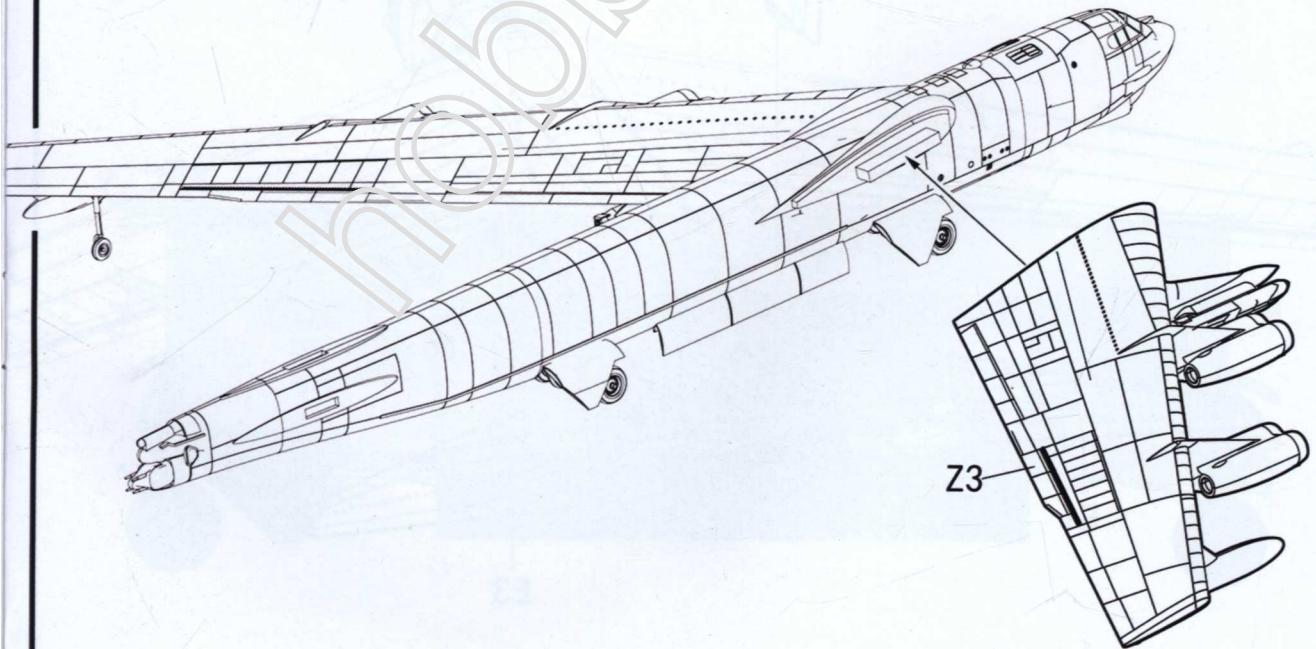

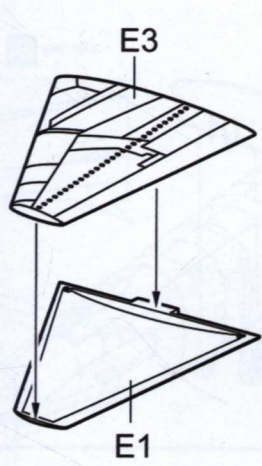

(E1)

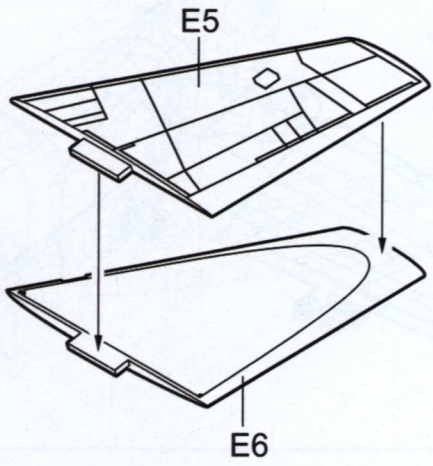

(E2)

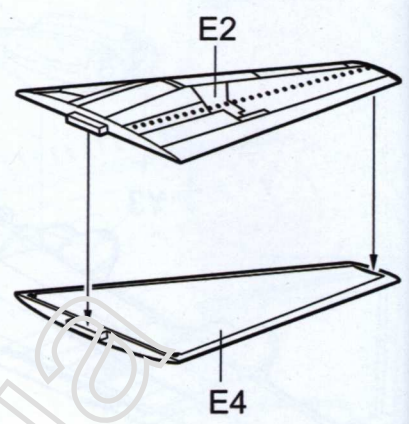

(E3)

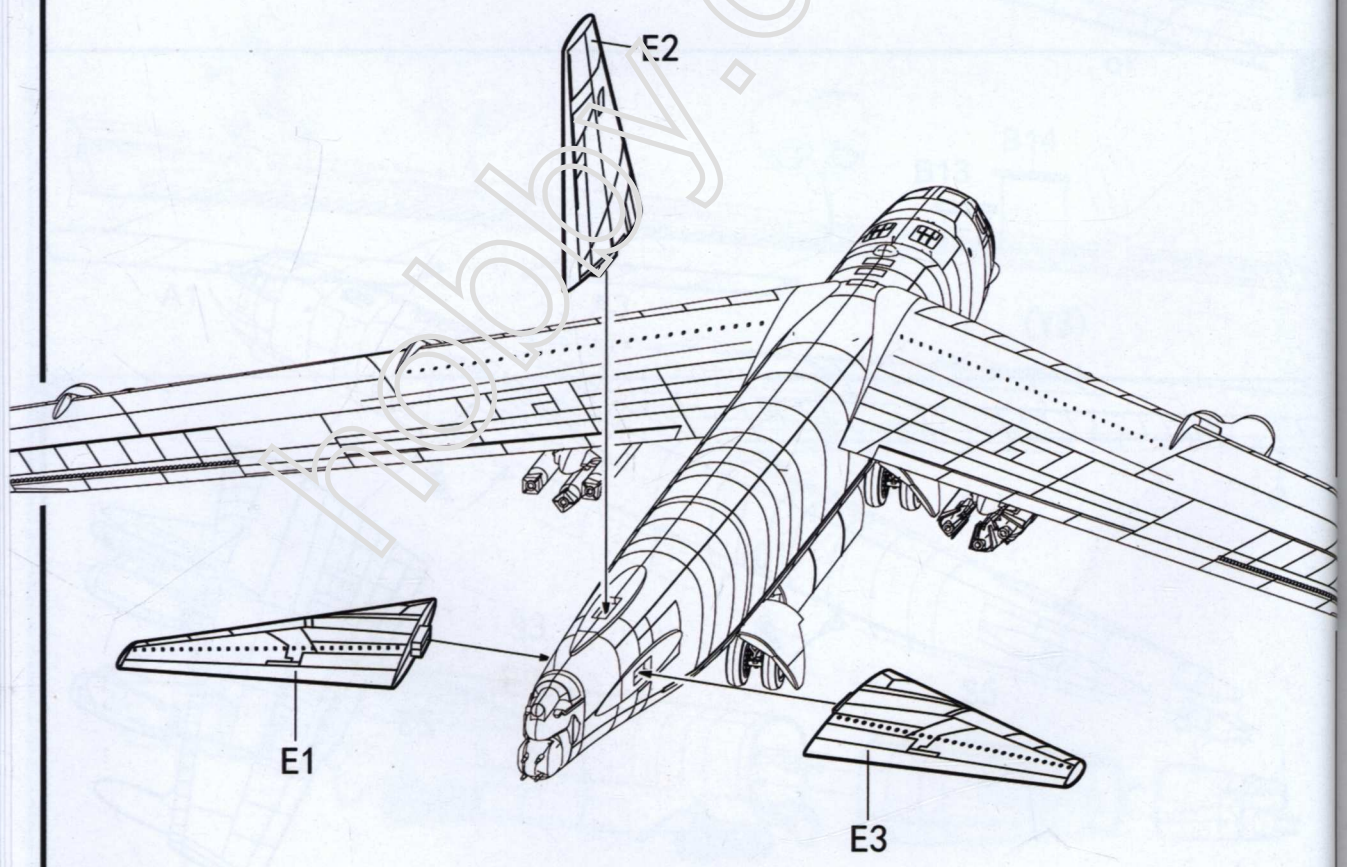

modelcollect

**DECALS AND COLOR SCHEME FOR
B-52G "OLD CROW EXPRESS"
OPERATION "DESERT STORM"
1708th BW(P), King Abdul
Aziz IAP, Jeddah (Jeddah New)
Saudi Arabia, March 1991**

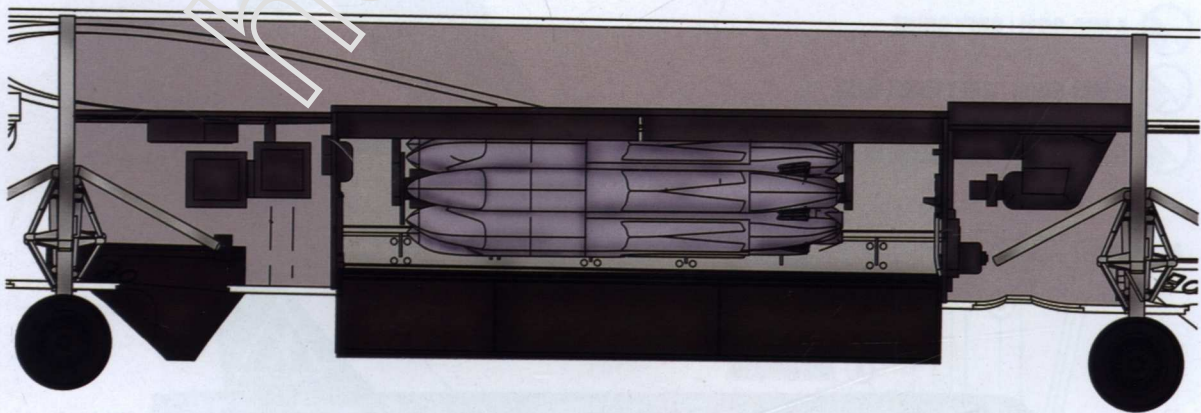
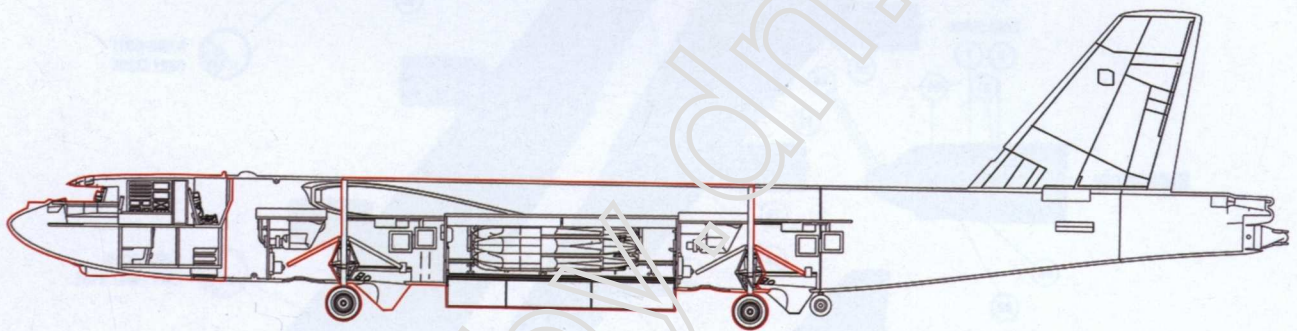
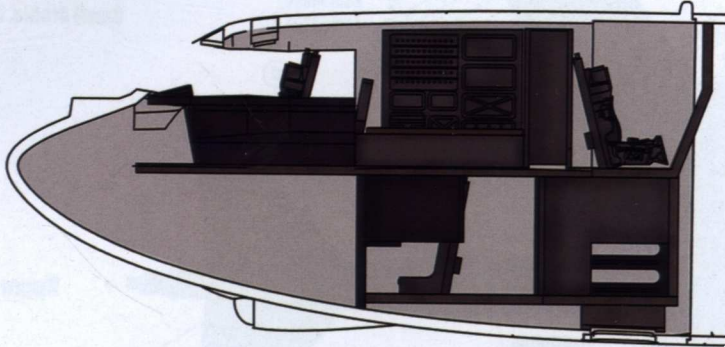

U.S. AIR FORCE SUBSONIC STRATEGIC BOMBER BOEING B52-G STRATOFORTRESS

modelcollect

DECALS AND COLOR SCHEME FOR
B-52G "OLD CROW EXPRESS"
OPERATION "DESERT STORM"
1708th BW(P), King Abdul
Aziz IAP, Jeddah (Jeddah New)
Saudi Arabia, March 1991



**Old
Crow
Express**

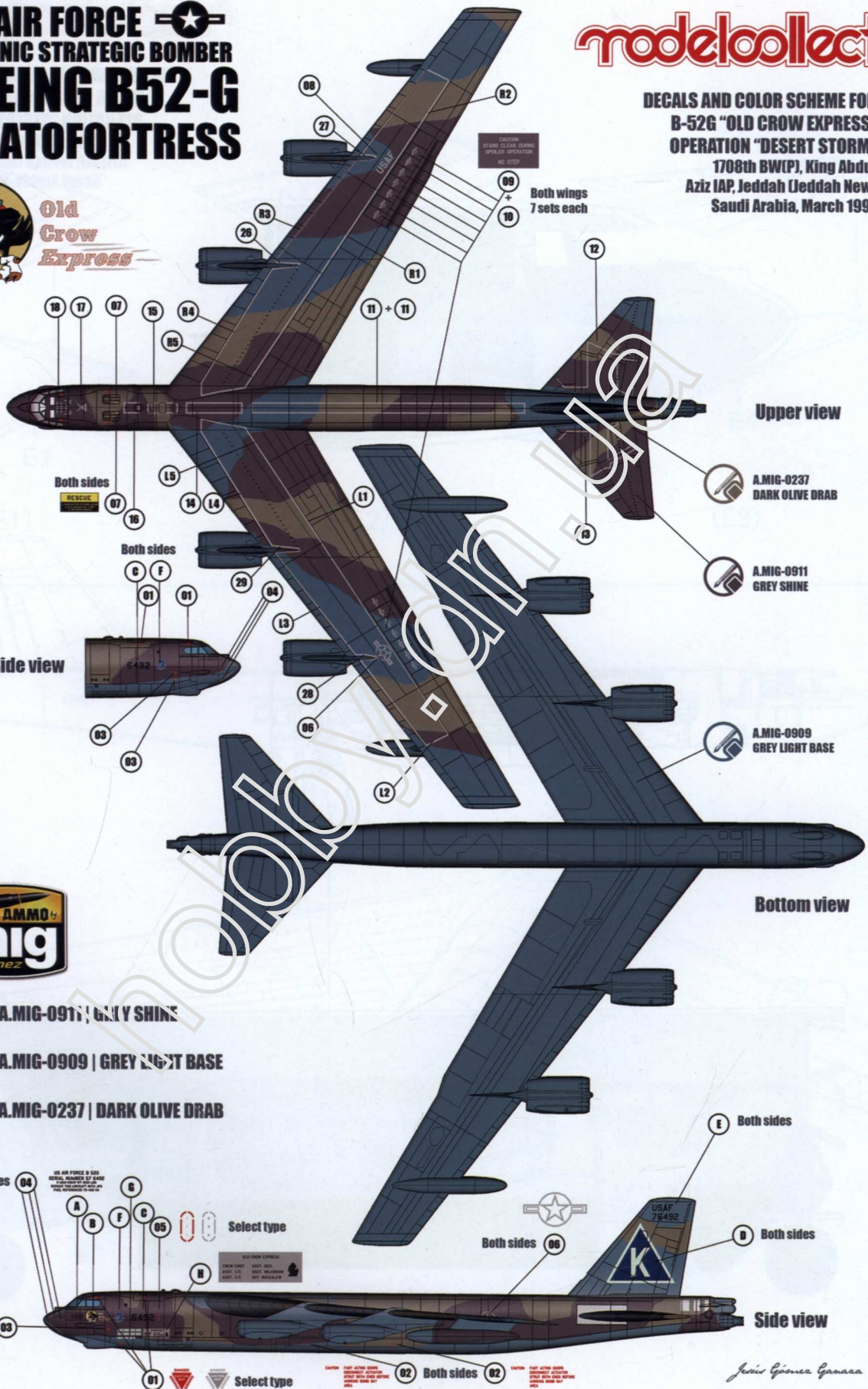

Upper view

A.MIG-0237
DARK OLIVE DRAB

A.MIG-0911
GREY SHINE

A.MIG-0909
GREY LIGHT BASE

Bottom view

Side view



A.MIG-0911 | GREY SHINE

A.MIG-0909 | GREY LIGHT BASE

A.MIG-0237 | DARK OLIVE DRAB

Both sides 04

US AIR FORCE 235
SERIAL NUMBER 74492

05

Select type

06

Both sides

07

Both sides

08

Both sides

09

Both wings
7 sets each

10

11 + 11

12

13

14

15

16

17

18

19

20

21

22

23

24

25

26

27

28

29

30

31

32

33

34

35

36

37

38

39

40

41

42

43

44

45

46

47

48

49

50

51

52

53

54

55

56

57

58

59

60

61

62

63

64

65

66

67

68

69

70

71

72

73

74

75

76

77

78

79

80

81

82

83

84

85

86

87

88

89

90

91

92

93

94

95

96

97

98

99

100

101

102

103

104

105

106

107

108

109

110

111

112

113

114

115

116

117

118

119

120

121

122

123

124

125

126

127

128

129

130

131

132

133

134

135

136

137

138

139

140

141

142

143

144

145

146

147

148

149

150

151

152

153

154

155

156

157

158

159

160

161

162

163

164

165

166

167

168

169

170

171

172

173

174

175

176

177

178

179

180

181

182

183

184

185

186

187

188

189

190

191

192

193

194

195

196

197

198

199

200

201

202

203

204

205

206

207

208

209

210

211

212

213

214

215

216

217

218

219

220

221

222

223

224

225

226

227

228

229

230

231

232

233

234

235

236

237

238

239

240

241

242

243

244

245

246

247

248

249

250

251

252

253

254

255

256

257

258

259

260

261

262

263

264

265

266

267

268

269

270

271

272

273

274

275

276

277

278

279

280

281

282

283

284

285

286

287

288

289

290

291

292

293

294

295

296

297

298

299

300

301

302

303

304

305

306

307

308

309

310

311

312

313

314

315

316

317

318

319

320

321

322

323

324

325

326

327

328

329

330

331

332

333

334

335

336

337

338

339

340

341

342

343

344

345

346

347

348

349

350

351

352

353

354

355

356

357

358

359

360

361

362

363

364

365

366

367

368

369

370

371

372

373

374

375

376

377

378

379

380

381

382

383

384

385

386

387

388

389

390

391

392

393

394

395

396

397

398

399

400

401

402

403

404

405

406

407

408

409

410

411

412

413

414

415

416

417

418

419

420

421

422

423

424

425

426

427

428

429

430

431

432

433

434

435

436

437

438

439

440

441

442

443

444

445

446

447

448

449

450

451

452

453

454

455

456

457

458

459

460

461

462

463

464

465

466

467

468

469

470

471

472

473

474

475

476

477

478

479

480

481

482

483

484

485

486

487

488

489

490

491

492

493

494

495

496

497

498

499

500

501

502

503

504

505

506

507

508

509

510

511

512

513

514

515

516

517

518

519

520

521

522

523

524

525

526

527

528

529

530

531

532

533

534

535

536

537

538

539

540

541

542

543

544

545

546

547

548

549

550

551

552

553

554

555

556

557

558

559

560

561

562

563

564

565

566

567

568

569

570

571

572

573

574

575

576

577

578

579

580

581

582

583

584

585

586

587

588

589

590

591

592

593

594

595

596

597

598

599

600

601

602

603

604

605

606

607

608

609

610

611

612

613

614

615

616

617

618

619

620

621

622

623

624

625

626

627

628

629

630

631

632

633

634

635

636

637

638

639

640

641

642

643

644

645

646

647

648

649

650

651

652

653

654

655

656

657

658

659

660

661

662

663

664

665

666

667

668

669

670

671

672

673

674

675

676

677

678

679

680

681

682

683

684

685

686

687

688

689

690

691

692

693

694

695

696

697

698

699

700

701

702

703

704

705

706

707

708

709

710

711

712

713

714

715

716

717

718

719

720

721

722

723

724

725

726

727

728

729

730

731

732

733

734

735

736

737

738

739

740

741

742

743

744

745

746

747

748

749

750

751

752

753

754

755

756

757

758

759

760

761

762

763

764

765

766

767

768

769

770

771

772

773

774

775

776

777

778

779

780

781

782

783

784

785

786

787

788

789

790

791

792

793

794

795

796

797

798

799

800

801

802

803

804

805

806

807

808

809

810

811

812

813

814

815

816

817

818

819

820

821

822

823

824

825

826

827

828

829

830

831

832

833

834

835

836

837

838

839

840

841

842

843

844

845

846

847

848

849

850

851

852

853

854

855

856

857

858

859

860

861

862

863

864

865

866

867

868

869

870

871

872

873

874

875

876

877

878

879

880

881

882

883

884

885

886

887

888

889

890

891

892

893

894

895

896

897

898

899

900

901

902

903

904

905

906

907

908

909

910

911

912

913

914

915

916

917

918

919

920

921

922

923

924

925

926

927

928

929

930

931

932

933

934

935

936

937

938

939

940

941

942

943

944

945

946

947

948

949

950

951

952

953

954

955

956

957

958

959

960

961

962

963

964

965

966

967

968

969

970

971

972

973

974

975

976

977

978

979

980

981

982

983

984

985

986

987

988

989

990

991

992

993

994

995

996

997

998

999

1000

Jesus Jimenez Jimenez